

REV 1 SH 7853 DWG NO	APPLICATION		REVISIONS					
	NEXT ASSY	USED ON	REV	DESCRIPTION	DATE	APPROVED		
	FINAL	6743-XX		DUPLICATE DRAWING DO NOT REVISE				

REV																							
SHEET	43	44	45	46	47	48	49	50															
REV																							
SHEET	20	21	22	23	24	25	26	27	28	29	30	31	32	33	34	35	36	37	38	39	40	41	42
REV STATUS OF SHEETS	REV	-	-	-	-																		
	SHEET	1	2	3	4	5	6	7	8	9	10	11	12	13	14	15	16	17	18	19			

UNLESS OTHERWISE SPECIFIED DIMENSION ARE IN INCHES TOLERANCES ARE FRACTIONS DECIMALS ANGLES ±1/64 .XX=±.02 ±1' .XXX=±.010	CONTRACT NO.		<b>M</b> <b>PC</b> <b>MONITOR PRODUCTS CO., INC.</b> <b>OCEANSIDE, CALIFORNIA</b>	
	APPROVALS	DATE		
MATERIAL	DRAWN	AWB	9/17/98	
	CHECKED	VLAD	9/17/98	
FINISH	ISSUED	LB	9/17/98	
DO NOT SCALE DRAWING	SIZE	CAGE CODE	DWG NO	REV
	A	54331	7853	—
	SCALE 4/1	CAD FILE	S6743XX1.A14	SHEET 1 of 4

REV —  
 SH 2  
 DWG NO 7853

- 1.0 MONITOR PART NUMBER 6743-XX
- 2.0 CLASSIFICATION OSCILLATOR, CRYSTAL, VOLTAGE CONTROLLED
- 3.0 ELECTRICAL CHARACTERISTICS (NOTE 1)
  - 3.1 NOMINAL FREQUENCY SEE TABLE 1 SHEET 3
    - 3.1.1 CALIBRATION TOLERANCE ±32 PPM WITH +1.65 VDC±.05 VDC INCLUSIVE
    - 3.1.2 ADJUSTMENT RANGE \_\_\_\_\_
      - 3.1.2.1 ADJUSTMENT RESOLUTION \_\_\_\_\_
    - 3.1.3 STABILITY
      - 3.1.3.1 FREQUENCY vs AMBIENT ±50 PPM/-40°C TO +85°C INCLUSIVE WITH +1.65 VDC ON PIN 1
      - 3.1.3.2 FREQUENCY vs VOLTAGE BETTER THAN 1 PPM FOR A 5% CHANGE
      - 3.1.3.3 FREQUENCY vs LOAD 2 x 10E-7 MAX FROM NO LOAD TO 15pF
      - 3.1.3.4 FREQUENCY vs TIME \_\_\_\_\_
        - 3.1.3.4.1 SHORT TERM 1 x 10E-9/100mS MAX
        - 3.1.3.4.2 LONG TERM 30 PPM MAX 10 YRS
        - 3.1.3.4.3 PHASE JITTER LESS THAN 0.2nS
        - 3.1.3.4.4 WARM UP TIME 1 SEC MAX
  - 3.2 WAVE FORM HCMOS COMPATIBLE
    - 3.2.1 SYMMETRY/THD 45%/55%
    - 3.2.2 AMPLITUDE LOGIC "0" = 10%MAX / LOGIC "1" = 90 MAX
    - 3.2.3 RISE/FALL TIME 10nS MAX
    - 3.2.4 LOAD 15pF
  - 3.3 VCXO TRANSFER CHARACTERISTICS
    - 3.3.1 TOTAL FREQUENCY CHANGE 0VDC TO +1.65VDC 200 PPM MIN  
+1.65VDC TO +3.30VDC 200 PPM MIN
    - 3.3.2 CONTROL VOLTAGE RANGE 0.VDC TO +3.30VDC
    - 3.3.3 SENSE POSITIVE
    - 3.3.4 LINEARITY ±20%
    - 3.3.5 MODULATION RATE/RESPONSE 10KHz OR GREATER
  - 3.4 POWER INPUT
    - 3.4.1 OSCILLATOR VOLTAGE/CURRENT +3.3VDC±5% / 25mA MAX
- 4.0 ENVIRONMENTAL
  - 4.1 AMBIENT TEMPERATURE RANGE
    - 4.1.1 OPERATING -40°C TO +85°C
    - 4.1.2 STORAGE -55°C TO +125°C
  - 4.2 VIBRATION 10-55 Hz 0.060"DIA 55Hz-200Hz 20G's
  - 4.3 SHOCK 1000G's 0.35 mS 1/2 SINE 3 SHOCKS EACH PLANE
  - 4.4 HUMIDITY 85% RH AT 85°C 1000HRS
  - 4.5 OTHER \_\_\_\_\_

NOTE 1 - ALL PERFORMANCE FIGURES ARE MEASURED UNDER THE FOLLOWING TEST CONDITION  
 A. AMBIENT TEMP. +25°C±5°C EXCEPT PARA 3.1.3.1  
 B. INPUT VOLTAGES: NOMINAL ±1% EXCEPT PARA 3.1.3.2.

SIZE	CAGE CODE	DWG NO	REV
A	54331	7853	—
SCALE 4/1	CAD FILE	S6742XX2.A14	SHEET 2 of 4

DWG NO 7853  
 SH 3  
 REV —

CHART 1					
DASH NO.	FREQUENCY (MHz)	DASH NO.	FREQUENCY (MHz)	DASH NO.	FREQUENCY (MHz)
-01	10.000000	-21	24.704000	-41	37.844000
-02	12.352000	-22	64.512000	-42	
-03	14.318180	-23	20.456000	-43	
-04	16.128000	-24	24.545400	-44	
-05	20.000000	-25	27.000000	-45	
-06	24.000000	-26	29.500000	-46	
-07	33.333333	-27	51.843200	-47	
-08	40.000000	-28	16.384000	-48	
-09	48.000000	-29	25.920000	-49	
-10	50.000000	-30	8.192000	-50	
-11	51.840000	-31	19.440000	-51	
-12	57.600000	-32	32.768000	-52	
-13	63.488000	-33	38.880000	-53	
-14	64.000000	-34	24.576000	-54	
-15	65.536000	-35	30.000000	-55	
-16	66.666666	-36	77.760000	-56	
-17	68.249600	-37	44.736000	-57	
-18	75.000000	-38	9.538086	-58	
-19	18.432000	-39	18.726000	-59	
-20	30.000000	-40	34.368000	-60	

SIZE	CAGE CODE	DWG NO	REV
A	54331	7853	—
SCALE 4/1	CAD FILE	S6742XX3.A14	SHEET 3 of 4

NOTES:

1. APPLICABLE STANDARDS/SPECIFICATION  
ANSI Y14.5M-1982, DIMENSIONS AND TOLERANCES
2. DIMENSIONS IN BRACKETS ARE METRIC
3. PIN NUMBERS ARE FOR REFERENCE ONLY

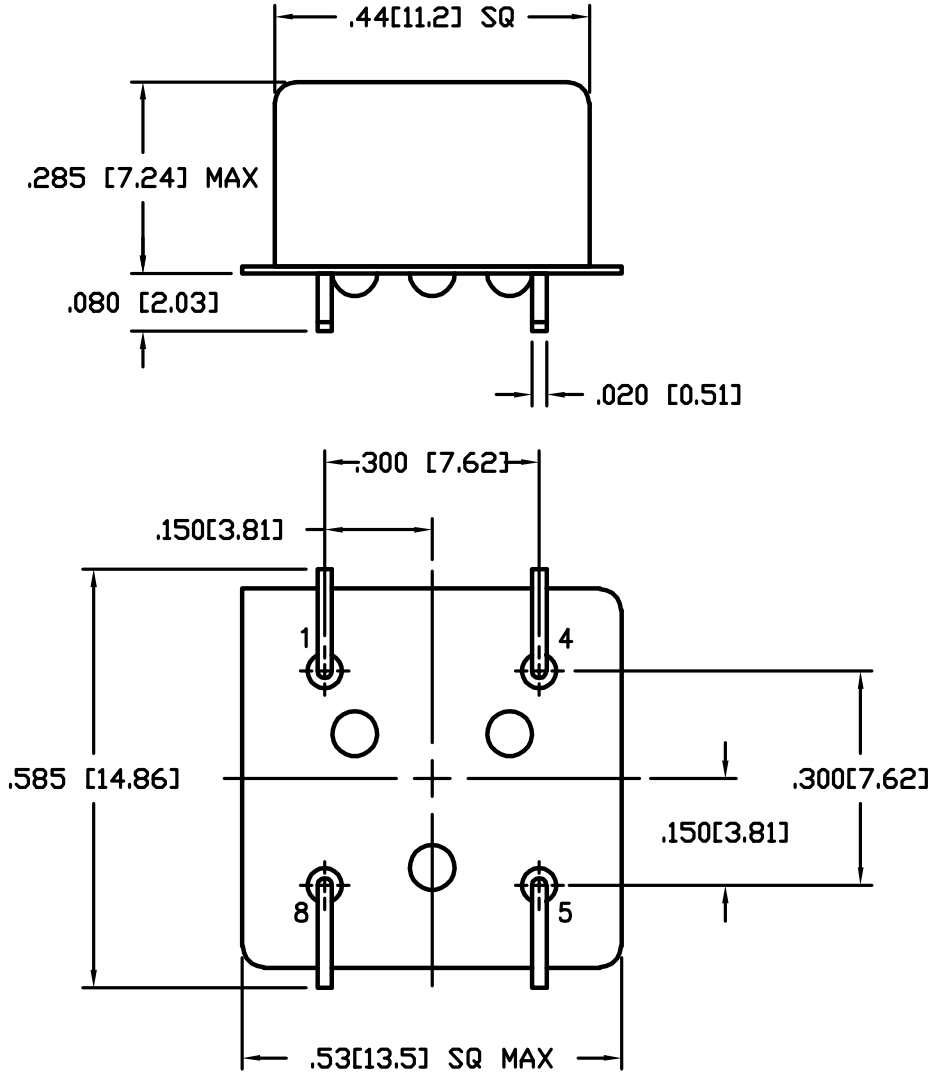

5.0 MECHANICAL

5.1 MATERIAL/FINISH NICKEL PLATED STEEL / HOT TIN DIPPED PINS

5.2 PIN CONNECTION

- 1. CONT VOLTAGE
- 4. GROUND
- 5. OUTPUT
- 8. +5 VDC

THIRD ANGLE PROJECTION

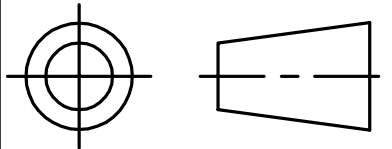

SIZE	CAGE CODE	DWG NO	REV
A	54331	7853	—
SCALE 4/1	CAD FILE S6742XX3.A14	SHEET	4 of 4