

# UM-4, UM-4S Series

# Crystals

STANDARD SPECIFICATIONS		EQUIVALENT SERIES RESISTANCE (E.S.R.)		
Frequency Range	7.000-160.000MHz	Frequency (MHz)	Vibration mode	UM-4, UM-4S
Crystal Cut	AT (Standard) or BT	7.0 ~ 9.9	Fundamental	100Ω max
Mode of Vibration	Fundamental, 3rd OT, 5th OT	10.0 ~ 14.9	Fundamental	60
Frequency Tolerance (25 °C)	±30ppm standard(see Appendix A for more details)	15.0 ~ 30.0	Fundamental	50
Load Capacitance (CL)	18pF Standard (see Appendix A for more details)	25.0 ~ 29.9	3rd OT	80
Shunt Capacitance(C <sub>0</sub> )	7 pF max (Standard)	30.0 ~ 49.9	3rd OT	60
Insulation resistance	500MΩ min / DC 100V	50.0 ~ 100.0	3rd OT	60
Frequency Stability	±50ppm standard (see Appendix A for more details)	75.0 ~ 160.0	5th OT	90
Aging	±5ppm / year max	*UM-4S is surface mounted type.		
Drive Level (μW)	30nW-1mW			
Operating Temp. Range	0 to +70 (see Appendix A for more details)			

### Ordering Instructions (see Appendix A for more details)

**Example: ILSI Part # = UM4-FB1FI18-20.000**

UM4-	±30ppm(@ 25°C)	±50ppm(Over Temp)	0°C~+70°C	Fundamental	Insulator Tab	Load Cap.	Freq.
	F	B	1	F	I	18pF	-20.000MHz

### DIMENSIONS(Unit:mm)

UM-4

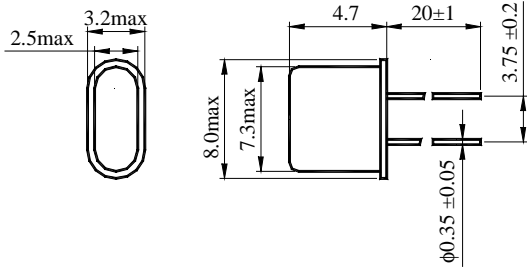

UM-4S

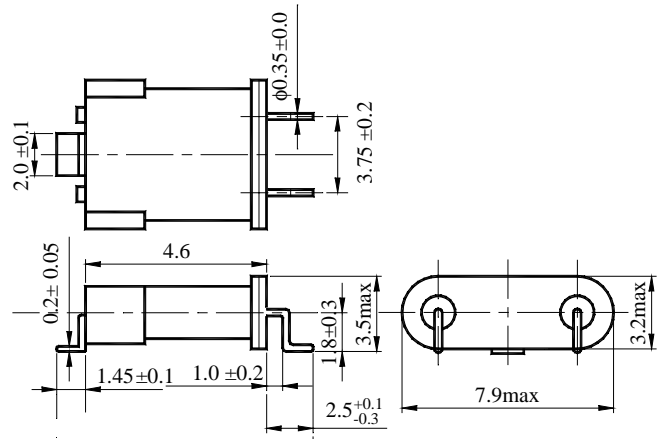

**ILSI America**

5458 Louie Lane Reno, NV 89511 Phone: 775-851-8880 • Fax: 775-851-8882

• email: [e-mail@ilsiamerica.com](mailto:e-mail@ilsiamerica.com) • [www.ilsiamerica.com](http://www.ilsiamerica.com)

Specifications subject to change without notice