



Features

- Single fiber bi-directional operation
- Laser diode with multi-quantum- well structure
- Low threshold current
- InGaAs/InP PIN Photodiode with TIA
- High sensitivity with AGC*
- Differential ended output
- Single +3.3V Power Supply
- Integrated WDM coupler
- Un-cooled operation from -40 to +85°C
- Hermetically sealed active component
- Single mode Single fiber pigtailed package with optional FC/ST/LC/SC/MU connector
- LC/SC BOSA
- Design for fiber optic networks application

Absolute Maximum Rating (Tc=25°C)

Parameter	Symbol	Value	Unit
Fiber Output Power L/M/H	P_f	0.6(L)/1(M)/2(H)	mW
LD Reverse Voltage	V_{RLD}	2	V
PIN-TIA Voltage	V_{CC}	4.5	V
Operating Temperature	T_{opr}	-40 to +85	°C
Storage Temperature	T_{stg}	-40 to +85	°C

Optical and Electrical Characteristics (Tc=25°C)

Parameter	Symbol	Min	Typical	Max	Unit	Test Condition
Laser Diode						
Optical Output Power	L	0.2	-	0.5	mW	CW, I _{th} + 25 mA , kink free
	M	0.5	-	1.0		
	H	1	1.6	-		
Peak Wavelength	λ	1530	1550	1570	nm	CW, P _f =P _f (Min)
Spectrum Width (RMS)	$\Delta\lambda$	-	-	3	nm	CW, P _f =P _f (Min)
Threshold Current	I _{th}	-	10	15	mA	CW
Forward Voltage	V _F	-	1.2	1.5	V	CW, P _f =P _f (Min)
Rise/Fall Time	t _r /t _f	-	-	0.3	ns	I _{bias} =I _{th} , 10% to 90%
Monitor Diode						
Monitor Current	I _m	100	-	-	μA	CW, P _f =P _f (Min), V _{RPD} =2V
Dark Current	I _{DARK}	-	-	0.1	μA	V _{RPD} =5V
Capacitance	C _t	-	6	15	pF	V _{RPD} =5V, f=1MHz
Module						
Tracking Error	$\Delta P_f/P_f$	-	-	±1.5	dB	APC, -40 to +85°C
Optical Crosstalk	CRT	-	< -45	-	dB	-

Detector DC Electrical Characteristics(Tc=25°C)

Parameter	Symbol	Min	Typical	Max	Unit	Test Condition	
Power Supply	V _{cc}	3.0	3.3	3.6	V		
Differential Output Voltage	V _d	F02	-	-	1	V	
		F04	-	-	0.6		
		F06	-	-	0.6		
Supply Current (no load)	I _{cc}	F02	-	-	35	mA	
		F04	-	30	40		
		F06	-	30	42		

Detector AC/Optical Electrical Characteristics(Tc=25°C)

Parameter	Symbol	Min	Typical	Max	Unit	Test Condition	
Detection Range		1100	1310	1430	nm	-	
Gain @ 10 Mbps Differential	G	F02	52	-	70	V/mW	λ=1310 nm
		F04	-	32	-		
		F06	-	8	-		
Bandwidth	BW	F02	120	140	-	MHz	
		F04	415	-	-		
		F06	830	-	-		
Saturation Power	P _{sat}	-3	0	-	dBm	λ=1310 nm	
Sensitivity	S _{ens}	F02	-	-38	-35	dBm	BER=10 ⁻¹⁰ @155Mbps
		F04	-	-31	-29		BER=10 ⁻¹⁰ @622Mbps
		F06	-	-25	-23		BER=10 ⁻¹⁰ @1.25Gbps
Output Resistance	R _{out}	-	50	-	ohm		

Ordering Information

C - 15/13 - FXX - PX - SXXX / XXX

1550nm Transmitter
1310nm Receiver

Package
P=Pigtail
B=BOSA

Connector
FC/ST/SC/MU/LC/-

- : PC Fiber
APC : APC Fiber

02: 155 Mb/s PIN-TIA + 3.3V
04: 622 Mb/s PIN-TIA + 3.3V
06: 1250 Mb/s PIN-TIA + 3.3V

Pin Assignment
“-” = A Type
D = D Type

Fiber Output Power
L/M/H

Pin Assignment

LD Pin Assignment

A Type

- Pin 1: Laser Cathode
- Pin 2: Laser Anode and Case Gnd
- Pin 3: Monitor Diode Anode
- Pin 4: Cathode

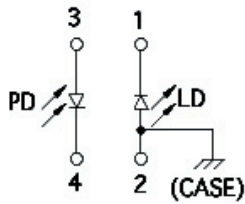

D Type

- Pin 1: Laser Anode and Monitor Diode Cathode
- Pin 2: Case Gnd
- Pin 3: Laser Cathode
- Pin 4: Monitor Diode Anode

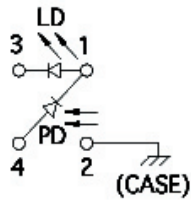

PIN-TIA Pin Assignment

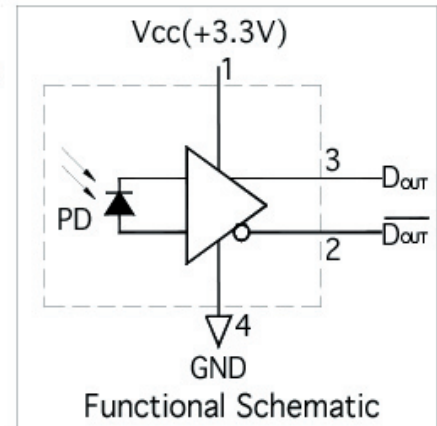

Outline Dimensions

C-15/13-Fxx-Bx-SLCx

Unit in mm

Top view

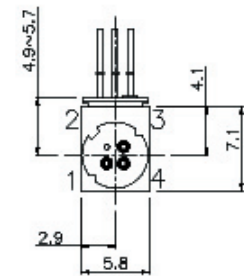
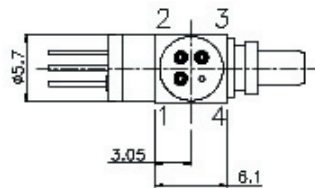

Left side view

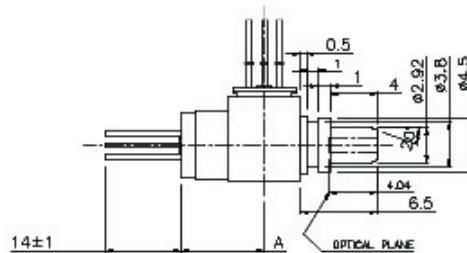

Front view

P.S.: A:6.7~7.3 mm (Low power)
A:9.0~9.6 mm (Middle & High power)

Outline Dimensions

C-15/13-Fxx-Bx-SSCx

Unit in mm

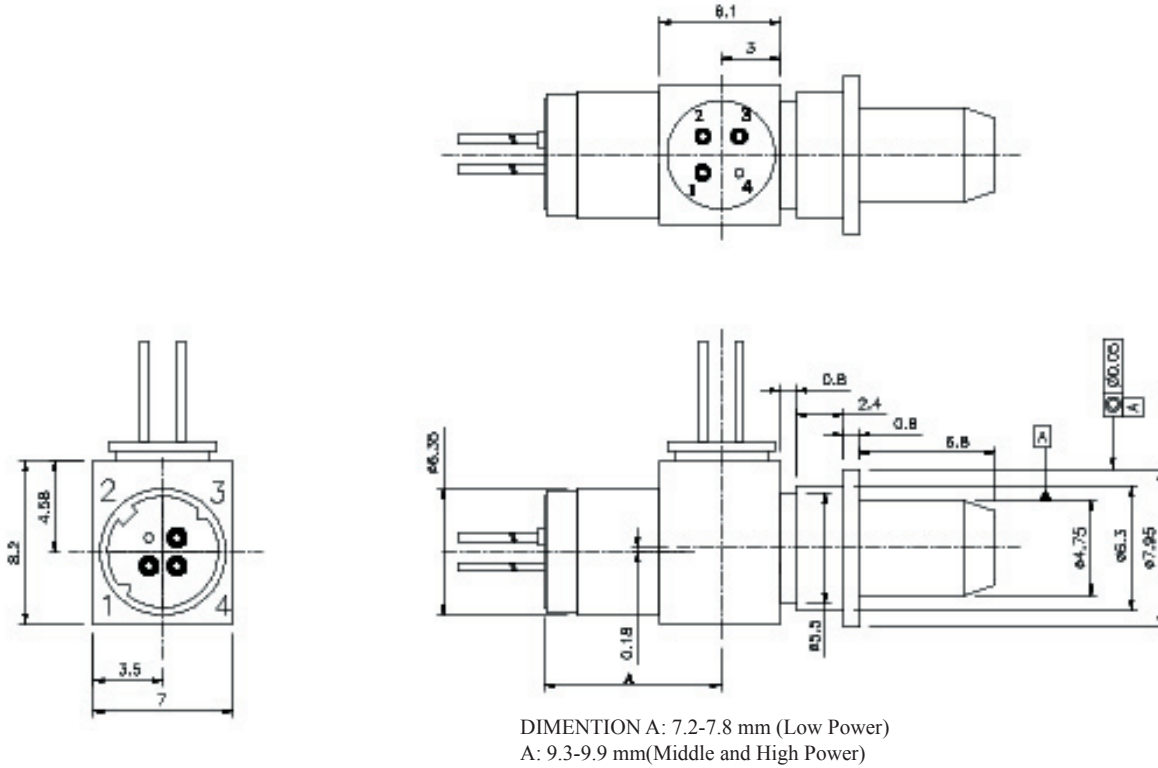

Outline Dimensions

C-15/13-Fxx-Px-Sxxx/xxx

Unit in mm

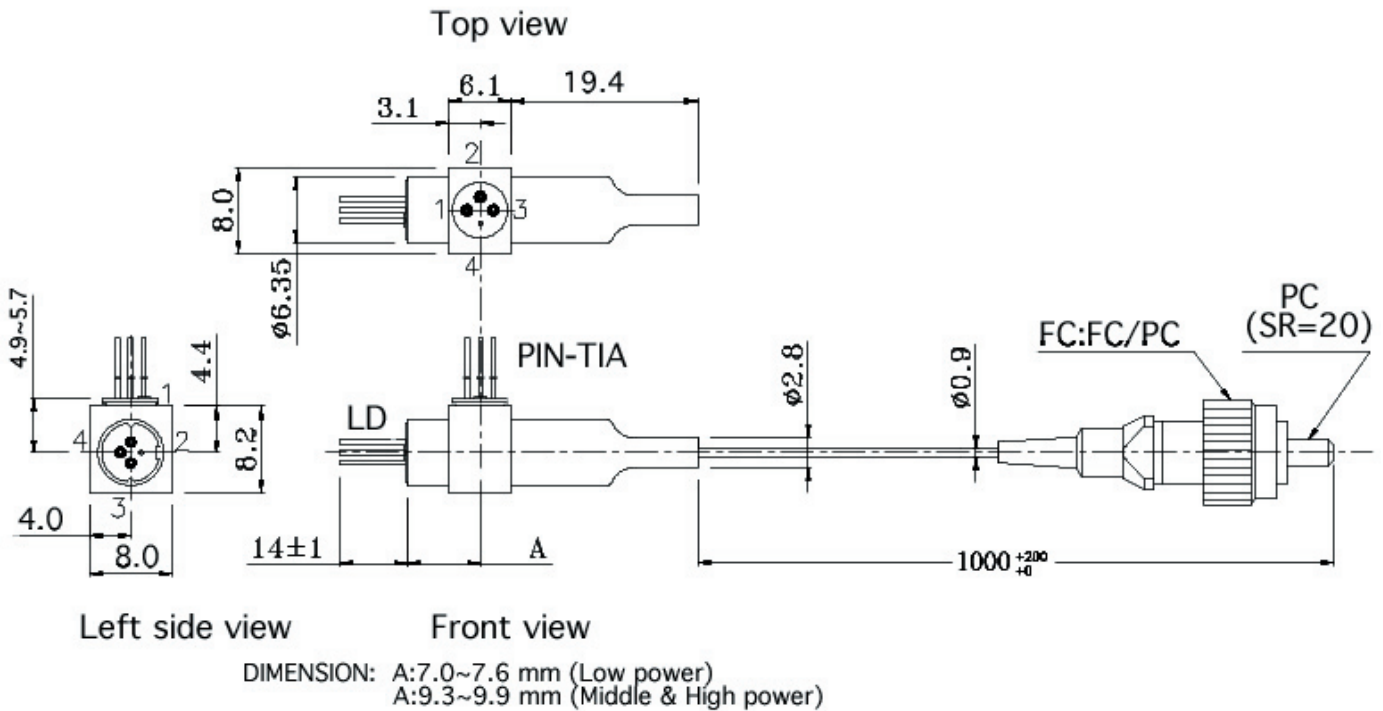

Warnings

Handling Precautions: This device is susceptible to damage as a result of electrostatic discharge (ESD). A static free environment is highly recommended. Follow guidelines according to proper ESD procedures.

Laser Safety: Radiation emitted by laser devices can be dangerous to human eyes. Avoid eye exposure to direct or indirect radiation.

Legal Notice

IMPORTANT NOTICE!

All information contained in this document is subject to change without notice, at LuminentOIC's sole and absolute discretion. LuminentOIC warrants performance of its products to current specifications only in accordance with the company's standard one-year warranty; however, specifications designated as "preliminary" are given to describe components only, and LuminentOIC expressly disclaims any and all warranties for said products, including express, implied, and statutory warranties, warranties of merchantability, fitness for a particular purpose, and non-infringement of proprietary rights. Please refer to the company's Terms and Conditions of Sale for further warranty information.

LuminentOIC assumes no liability for applications assistance, customer product design, software performance, or infringement of patents, services, or intellectual property described herein. No license, either express or implied, is granted under any patent right, copyright, or intellectual property right, and LuminentOIC makes no representations or warranties that the product(s) described herein are free from patent, copyright, or intellectual property rights. Products described in this document are NOT intended for use in implantation or other life support applications where malfunction may result in injury or death to persons. LuminentOIC customers using or selling products for use in such applications do so at their own risk and agree to fully defend and indemnify LuminentOIC for any damages resulting from such use or sale.

THE INFORMATION CONTAINED IN THIS DOCUMENT IS PROVIDED ON AN "AS IS" BASIS. Customer agrees that LuminentOIC is not liable for any actual, consequential, exemplary, or other damages arising directly or indirectly from any use of the information contained in this document. Customer must contact LuminentOIC to obtain the latest version of this publication to verify, before placing any order, that the information contained herein is current.

© LuminentOIC, Inc. 2003
All rights reserved