

# SMT Power Inductor

## SIL620 Type

### Features

- Small size (5.6mm\*5.6mm), low profile (2.0mm max. Height) SMD type.
- Magnetically shielded, suitable for high density mounting.
- High energy storage and low DCR.
- Provided with embossed carrier tape packing.
- Ideal for power source circuits, DC-DC converter, DC-AC inverters inductor application.
- In addition to the standard versions shown here, custom inductors are available to meet your exact requirements.

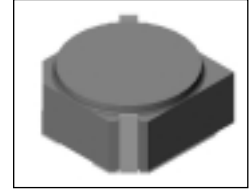

### Mechanical Dimension: Unit: mm

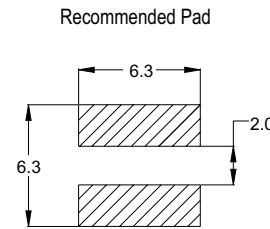
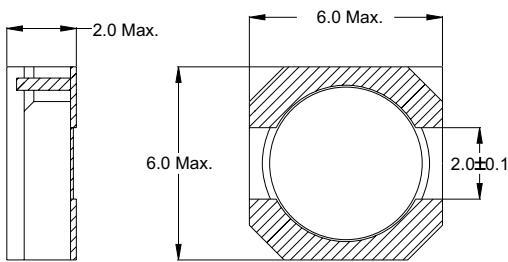

### Electrical Characteristics:

PART NO.	L * ( $\mu$ H)	DCR ( $\Omega$ ) MAX	I <sub>RATED</sub> ** (A)
SIL620 - 4R1	4.1	0.057	1.95
SIL620 - 5R4	5.4	0.076	1.60
SIL620 - 6R2	6.2	0.096	1.40
SIL620 - 8R9	8.9	0.116	1.25
SIL620 - 100	10	0.124	1.20
SIL620 - 120	12	0.153	1.10
SIL620 - 150	15	0.196	0.97
SIL620 - 180	18	0.210	0.85
SIL620 - 220	22	0.290	0.80
SIL620 - 270	27	0.330	0.75
SIL620 - 330	33	0.386	0.65
SIL620 - 390	39	0.520	0.57
SIL620 - 470	47	0.595	0.54
SIL620 - 560	56	0.665	0.50
SIL620 - 680	68	0.840	0.43
SIL620 - 820	82	0.978	0.41
SIL620 - 101	100	1.200	0.36

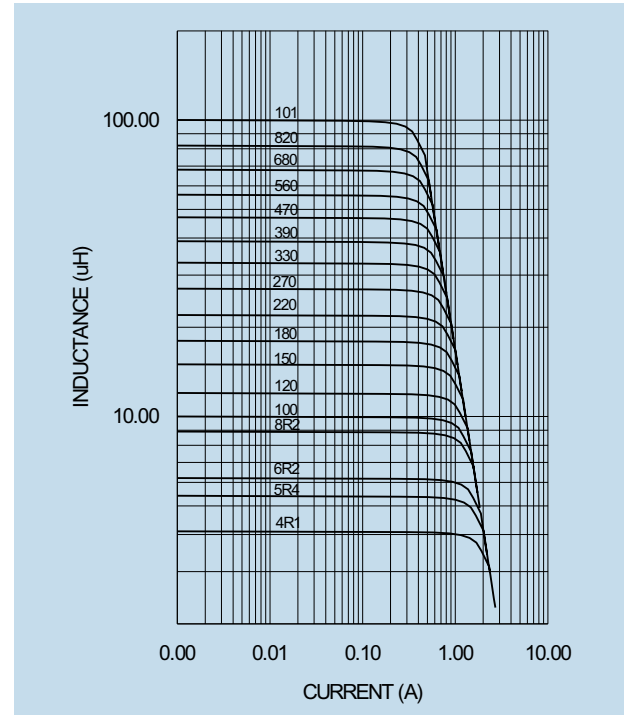

★ Tolerance of inductance  
4.1~100 $\mu$ H $\pm$ 30%

★★ I<sub>RATED</sub>: rated current.  $\Delta$ L<35%,  $\Delta$ T<45°C at I<sub>RATED</sub>

★★★ Operating temperature: -20°C to 105°C (including self-temperature rise)

★★★★ Test condition at 25°C: 100KHz, 0.1V



沙井欣旺电子有限公司

XINWANG ELECTRONICS, INC.  
TEL: 0755-29696626 FAX: 0755-27289711  
E-mail: zhangxf815@163.com