

RNP SERIES

ALUMINUM ELECTROLYTIC CAPACITORS

Speaker Network, Bi-Polar, Radial Leads

Features

- Bi-polar, Radial
- For speaker crossover networks, Hi-fi audio.
- Excellent frequency characteristics
- Low dissipation factor
- load life of 1000 hours at 85°C

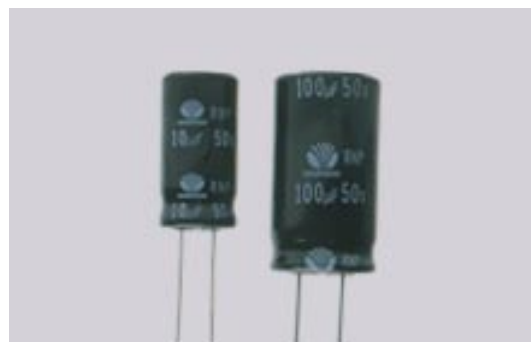

Specifications

Item	Performance Characteristics		
Operating temperature range	-40°C ~ +85°C		
Rated working voltage range	25V ~ 50V		
Nominal capacitance range	1.0µF ~ 100µF, ±20% or ±10% (at 20°C, 120Hz)		
D.C Leakage current (at 20°C)	The following specifications shall be satisfied when the rated voltage is applied for the required time. $I \leq 0.04CV + 10\mu A (5 \text{ min})$ Where I=Leakage current (µA) C=Nominal capacitance (µF) V=Rated voltage (V)		
Tan δ (max., at 20°C, 120Hz)	W.V (V)	25	50
	120Hz	0.1	0.075
	10KHz (10µF ≥)	0.2	0.1
	1KHz (10µF <)	0.2	0.1
Characteristics of impedance	W.V (V)	25	50
	*Impedance (Ω) at 20KHz x Nominal capacitance (µF)		
Load life	After applying rated working voltage for 1000 hours at +85°C with the polarity inverted every 250 hours and then being stabilized at +20°C, capacitors shall meet following limits. δ		
	Capacitance change	Within ±20% of initial measured value	
Shelf life	Tan	≤ 200% of initial specified value	
	Leakage current	≤ Initial specified value	
	After storage for 500hours at +85°C with no voltage applied and then being stabilized at +20°C, capacitors shall meet following limits.		
	Capacitance change	Within +20% of initial measured value	

Case sizes and Dimensions

Dimensions & Maximum permissible ripple current [mA(rms) at 85°C, 120Hz]

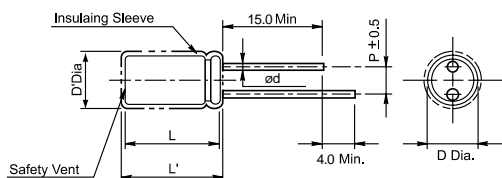

Standard lead style

øD	10.0	13.0	16.0	18.0
p	5.0		7.5	
ød				

D' = [D+0.5]Max. L' = [L+1.5]Max. at D ≥ 10.0

Cap(µF)	WV	25		50	
		Case Size	I _r	Case Size	I _r
1.0		10x16	33	10x20	38
1.5		10x20	40	10x20	46
2.2		10x20	48	13x25	71
3.3		10x20	59	13x25	88
4.7		13x20	82	13x25	104
6.8		13x20	98	13x25	126
10		13x20	121	13x25	153
15		13x20	150	13x25	187
22		13x20	180	13x25	226
33		13x25	237	16x25	312
47		13x25	290	16x25	373
68		13x25	340	16x25	441
100		16x25	474		638