

Choke Coil for Against the Harmonics

Indonesia

Series: **HSC-II**

Type: **T**



36 Type

42 Type

45 Type

Suppressed the harmonic current from switching power supply

■ **Harmonics std.**

- National standard: MITI Guideline, class D equipment
- International standard: IEC1000-3-2 Class D equipment

■ **Safety std.**

- Denki Yohin*, IEC, etc.
- Temp class : E

■ **Industrial Properties**

- Patents: 1 pending

■ **Features**

- New core structure for low leakage flux
- Reduce EMC-noise by using in both line
- Effective for harmonic regulation by connecting on input power line

■ **Recommended Applications**

- TV, Display
- Printer, FAX, Copier
- Industrial equipment with switching power supply

■ **Explanation of Part Numbers**

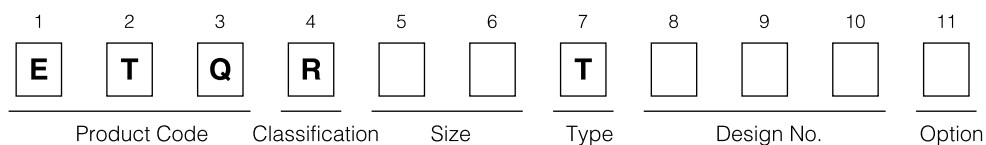

*Denki Yohin stands for the safety regulations under The Electrical Appliance and Material Control Law

■ Rated (Reference)

● U36-20 Size

Input Voltage	Sample	Active Power(W)	Inductance(mH)	Current(A)	Recommendation Pattern
100 V	ZTQ36 - 50J□	50 to 85	20.0	1.25	fig.1 ① or ②
	ZTQ36 - 60J□	60 to 90	18.0	1.35	
	ZTQ36 - 75J□	75 to 100	15.0	1.50	
	ZTQ36 - 80J□	80 to 125	12.0	1.70	
	ZTQ36 - 105J□	105 to 130	9.5	1.80	
230 V	ZTQ36 - 115J□	115 to 145	8.3	1.95	
	ZTQ36 - 50Y□	50 to 85	100.0	0.55	
	ZTQ36 - 65Y□	65 to 95	85.0	0.60	
	ZTQ36 - 75Y□	75 to 120	65.0	0.75	
	ZTQ36 - 105Y□	105 to 130	55.0	0.80	
	ZTQ36 - 135Y□	135 to 145	40.0	0.90	

[Type of sample ZTQ36-50J□]

A : Dual line connection, B : Single line connection, R : Leaded wire type

● U42-13 Size

Input Voltage	Sample	Active Power(W)	Inductance(mH)	Current(A)	Recommendation Pattern
100 V	ZTQ42C - 50J□	50 to 90	20.0	1.45	fig.2 ③ or ④
	ZTQ42C - 75J□	75 to 130	14.0	1.80	
	ZTQ42C - 105J□	105 to 175	9.3	2.30	
	ZTQ42C - 135J□	130 to 195	7.0	2.70	
	ZTQ42C - 170J□	140 to 220	5.0	3.00	
230 V	ZTQ42C - 50Y□	50 to 100	105.0	0.65	
	ZTQ42C - 75Y□	75 to 145	62.0	0.90	
	ZTQ42C - 105Y□	105 to 155	55.0	0.93	
	ZTQ42C - 135Y□	120 to 170	45.0	1.05	

[Type of sample ZTQ42-50J□]

A : Dual line connection, B : Single line connection, R : Leaded wire type

● U42-20 Size

Input Voltage	Sample	Active Power(W)	Inductance(mH)	Current(A)	Recommendation Pattern
100 V	ZTQ42 - 50J□	50 to 120	20.0	1.60	fig.2 ③ or ④
	ZTQ42 - 75J□	75 to 140	14.5	1.90	
	ZTQ42 - 80J□	80 to 165	12.0	2.20	
	ZTQ42 - 110J□	110 to 180	8.5	2.40	
	ZTQ42 - 140J□	140 to 200	6.5	2.75	
230 V	ZTQ42 - 50Y□	50 to 115	103.0	0.70	
	ZTQ42 - 65Y□	65 to 120	85.0	0.75	
	ZTQ42 - 75Y□	75 to 150	65.0	0.90	
	ZTQ42 - 105Y□	105 to 160	55.0	1.00	
	ZTQ42 - 120Y□	120 to 180	45.0	1.10	
	ZTQ42 - 155Y□	155 to 205	35.0	1.25	

[Type of sample ZTQ42-50J□]

A : Dual line connection, B : Single line connection, R : Leaded wire type

● U45-17 Size

Input Voltage	Sample	Active Power(W)	Inductance(mH)	Current(A)	Recommendation Pattern
100 V	ZTQ45 - 50J□	50 to 140	20.0	1.85	fig.2 ③ or ④
	ZTQ45 - 75J□	75 to 170	15.0	2.25	
	ZTQ45 - 80J□	80 to 180	12.0	2.40	
	ZTQ45 - 110J□	110 to 215	8.5	2.90	
	ZTQ45 - 145J□	145 to 240	6.0	3.20	
	ZTQ45 - 170J□	170 to 270	5.0	3.70	
	ZTQ45 - 185J□	185 to 300	4.5	4.00	
230 V	ZTQ45 - 50Y□	50 to 130	105.0	0.80	
	ZTQ45 - 65Y□	65 to 150	85.0	0.90	
	ZTQ45 - 75Y□	75 to 170	65.0	1.05	
	ZTQ45 - 105Y□	105 to 180	55.0	1.10	
	ZTQ45 - 120Y□	120 to 215	45.0	1.30	
	ZTQ45 - 135Y□	135 to 240	40.0	1.45	
	ZTQ45 - 155Y□	155 to 250	35.0	1.50	

[Type of sample ZTQ45-50J□]

A : Dual line connection, B : Single line connection, R : Leaded wire type

■ Dimensions in mm (not to scale)

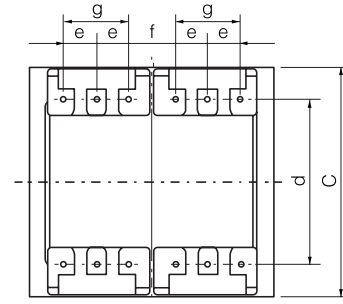
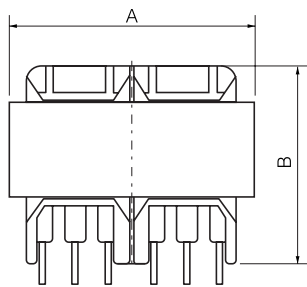

	A	B	C	d	e	f	g
U36-20	37 max.	41 max.	32 max.	21.0	-	6.0	9.0
U42-13	47 max.	32 max.	38 max.	30.0	6.0	8.5	12.0
U42-20	44 max.	41 max.	38 max.	25.0	5.5	7.0	11.0
U45-17	47 max.	39 max.	44 max.	30.0	6.0	8.5	12.0

■ Recommendation Pattern

<p>fig.1</p>	<p>Dual lines (Separate connection)</p> <p>①</p>	<p>Single line (Series connection)</p> <p>②</p> <ul style="list-style-type: none"> ● Please connect the #2 and #3 in PCB circuit ● #6 is without pin
<p>fig.2</p>	<p>③</p>	<p>④</p> <ul style="list-style-type: none"> ● Please connect the #3 and #4 in PCB circuit ● #10 is without pin

■ Recommended PWB Piercing (Dimensions in mm)

(Bottom View)

U36-20 Size

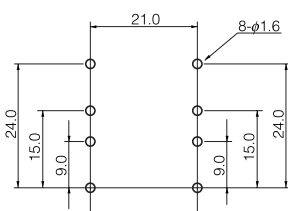

U42-20 Size

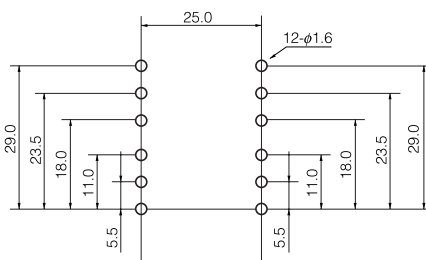

U42-13 Size
U45-17 Size

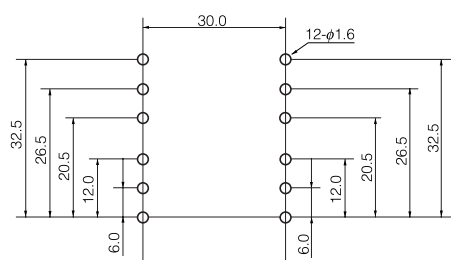

Performance Characteristics

Leakage Flux

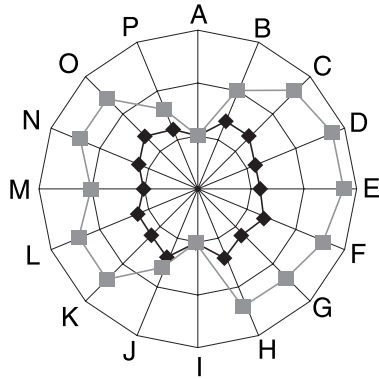

NEW

◆ HSC-II

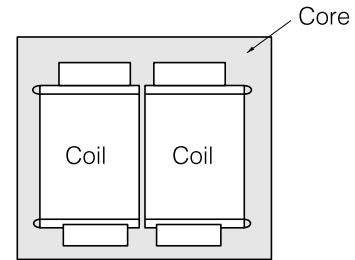

■ Panasonic Current type

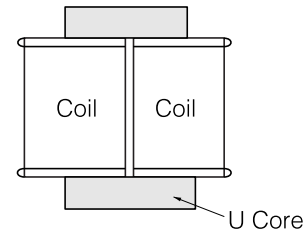

EMC Noise Characteristics (VCCI class2)

Without Choke Coils

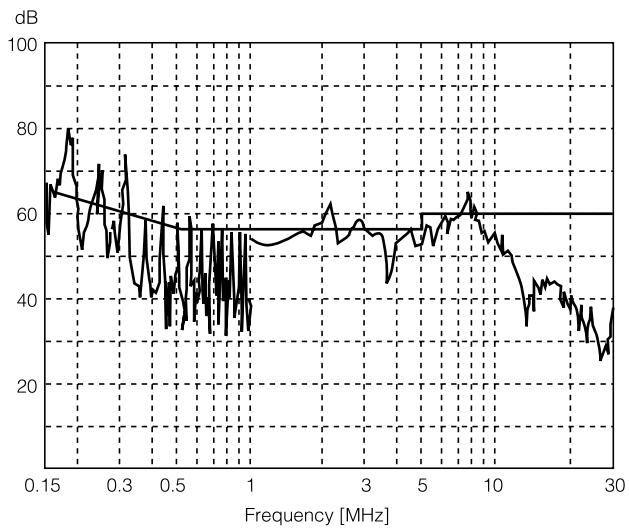

With Choke Coils

