

Screw Terminal Type

Series:GYU

■ Features Endurance : +85°C 2000 h

Japan
U.S.A.



■ Recommended Applications

Suitable for the circuits of switching power supply, computer, inverter

■ Specifications

Category temp. range	-40 to +85°C	-25 to +85°C
Rated W.V. Range	10 to 100 V .DC	160 to 250 V .DC
Nominal Cap. Range	5600 to 1000000 μF	1200 to 27000 μF
Capacitance Tolerance	-10 to +30% (120Hz/+20°C)	
DC Leakage Current	30CV̄ (μA) max. after 5 minutes application of rated working voltage +20°C C: Capacitance(μF) V: W.V. (V.DC)	
Dissipation Factor	Please see the attached standard products list	
Endurance	After 2000 hours application of DC voltage with specified ripple current (< rated DC working voltage) at +85°C, the capacitor shall meet the following limits.	
	Capacitance change	±20 % of initial measured value
	D.F.	<150 % of initial specified value
Shelf Life	After storage for 1000hours at +85±2 °C with no voltage applied and then being stabilized at +20 °C, capacitors shall meet the limits specified in "Endurance".(With voltage treatment)	

■ Frequency Correction Factor for Ripple Current

W.V.(V)	φD(mm)	Freq.(Hz)	50	60	120	300	360	1k	10k to
10 to 50	36		0.95	0.96	1.00	1.02	1.03	1.04	1.04
	51, 64		0.97	0.98	1.00	1.01	1.02	1.03	1.03
	77, 90		0.98	0.99	1.00	1.01	1.02	1.03	1.03
63, 80	36		0.92	0.95	1.00	1.06	1.08	1.11	1.12
	51, 64		0.94	0.96	1.00	1.05	1.07	1.10	1.11
	77, 90		0.96	0.97	1.00	1.03	1.05	1.08	1.09
100	36		0.90	0.94	1.00	1.06	1.09	1.13	1.15
	51, 64		0.93	0.97	1.00	1.04	1.06	1.10	1.13
	77, 90		0.95	0.98	1.00	1.02	1.03	1.07	1.08
160, 200	36		0.80	0.86	1.00	1.07	1.08	1.12	1.17
	51, 64		0.86	0.91	1.00	1.05	1.06	1.08	1.10
	77, 90		0.90	0.95	1.00	1.05	1.06	1.08	1.10
250	36		0.71	0.79	1.00	1.09	1.10	1.15	1.21
	51, 64		0.83	0.88	1.00	1.07	1.08	1.13	1.20
	77, 90		0.85	0.90	1.00	1.05	1.06	1.11	1.20

■ Dimensions in mm (not to scale)

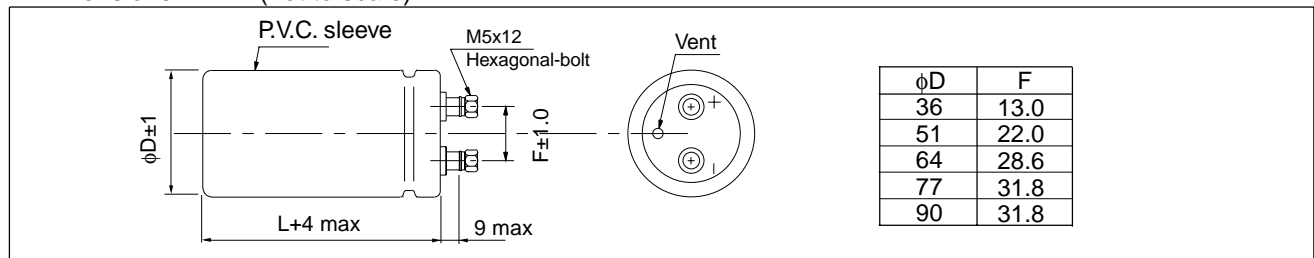

■ Mounting clamp

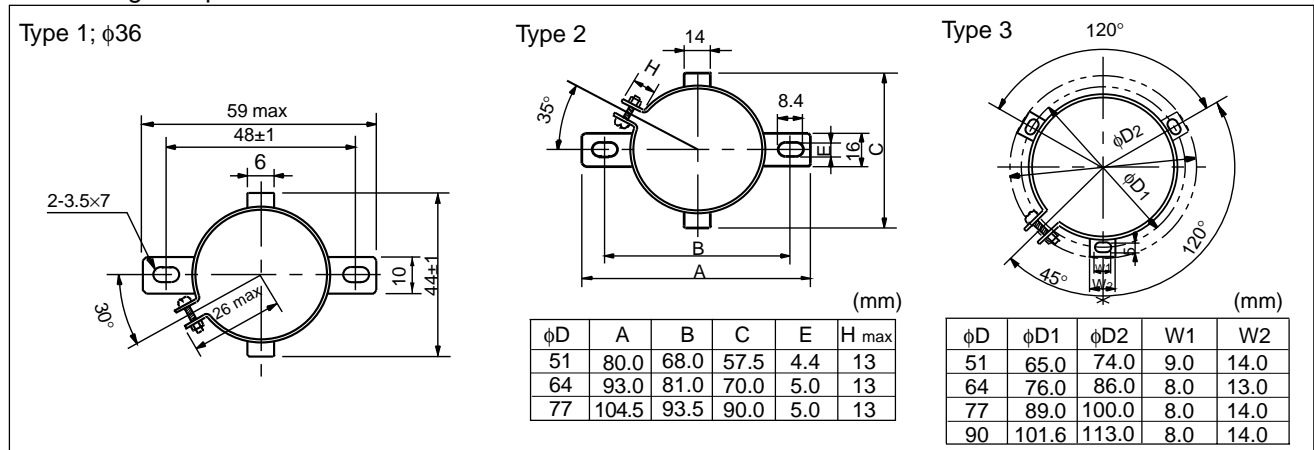

Design, Specifications are subject to change without notice. Ask factory for technical specifications before purchase and/or use. Whenever a doubt about safety arises from this product, please inform us immediately for technical consultation without fail.

■ Standard Products

W.V. (V)	Cap. (10 to +30%) (μ F)	Case size		Specification		Terminal Pitch (mm)	Part No.	(:) Mounting Clamp		
		Dia. (mm)	Length (mm)	Ripple current (120Hz) (+85 \dot{u} C) (A)	D.F. (120Hz) (+20 \dot{u} C)			No	2point clamp	3point clamp
10	68000	36	83	5.9	0.45	13.0	ECEG1AU683P()	N	F	
	82000	36	103	7.1	0.45	13.0	ECEG1AU823N()	N	F	
	100000	36	125	8.5	0.45	13.0	ECEG1AU104M()	N	F	
	150000	51	83	10.0	0.65	22.0	ECEG1AU154L()	N	C	F
	220000	51	103	13.1	0.65	22.0	ECEG1AU224K()	N	C	F
	270000	51	125	15.6	0.65	22.0	ECEG1AU274J()	N	C	F
	330000	51	145	17.5	0.65	22.0	ECEG1AU334H()	N	C	F
			64	103	17.5	0.90	28.6	ECEG1AU334G()	N	C
	390000	64	125	20.6	0.90	28.6	ECEG1AU394F()	N	C	F
	560000	64	145	26.2	0.90	28.6	ECEG1AU564E()	N	C	F
	680000	77	125	26.8	1.60	31.8	ECEG1AU684D()	N	C	F
	820000	77	145	29.4	1.60	31.8	ECEG1AU824C()	N	C	F
1000000	90	150	30.6	2.00	31.8	ECEG1AU105A()	N		F	
16	39000	36	83	5.5	0.40	13.0	ECEG1CU393P()	N	F	
	56000	36	103	7.3	0.40	13.0	ECEG1CU563N()	N	F	
	68000	36	125	8.8	0.40	13.0	ECEG1CU683M()	N	F	
	100000	51	83	9.6	0.60	22.0	ECEG1CU104L()	N	C	F
	120000	51	103	11.3	0.60	22.0	ECEG1CU124K()	N	C	F
	150000	51	125	13.8	0.60	22.0	ECEG1CU154J()	N	C	F
	180000	51	145	14.1	0.60	22.0	ECEG1CU184H()	N	C	F
	220000	64	103	15.6	0.75	28.6	ECEG1CU224G()	N	C	F
	270000	64	125	18.7	0.75	28.6	ECEG1CU274F()	N	C	F
	330000	64	145	21.9	0.75	28.6	ECEG1CU334E()	N	C	F
	390000	77	125	23.1	1.10	31.8	ECEG1CU394D()	N	C	F
	470000	77	145	26.9	1.10	31.8	ECEG1CU474C()	N	C	F
680000	90	150	30.6	1.50	31.8	ECEG1CU684A()	N		F	
25	27000	36	83	5.8	0.35	13.0	ECEG1EU273P()	N	F	
	39000	36	103	7.5	0.35	13.0	ECEG1EU393N()	N	F	
	47000	36	125	9.0	0.35	13.0	ECEG1EU473M()	N	F	
	82000	51	83	10.0	0.55	22.0	ECEG1EU823L()	N	C	F
	100000	51	103	11.9	0.55	22.0	ECEG1EU104K()	N	C	F
	120000	51	125	14.4	0.55	22.0	ECEG1EU124J()	N	C	F
	150000	51	145	16.9	0.55	22.0	ECEG1EU154H()	N	C	F
	180000	64	103	17.5	0.65	28.6	ECEG1EU184G()	N	C	F
	220000	64	125	18.8	0.65	28.6	ECEG1EU224F()	N	C	F
	270000	64	145	22.5	0.65	28.6	ECEG1EU274E()	N	C	F
	330000	77	125	23.1	0.75	31.8	ECEG1EU334D()	N	C	F
	390000	77	145	26.9	0.75	31.8	ECEG1EU394C()	N	C	F
470000	90	150	29.4	1.0	31.8	ECEG1EU474A()	N		F	
35	22000	36	83	5.2	0.30	13.0	ECEG1VU223P()	N	F	
	27000	36	103	6.2	0.30	13.0	ECEG1VU273N()	N	F	
	33000	36	125	7.5	0.30	13.0	ECEG1VU333M()	N	F	

Endurance : 85 \dot{u} C 2000h

Design, Specifications are subject to change without notice. Ask factory for technical specifications before purchase and/or use. Whenever a doubt about safety arises from this product, please inform us immediately for technical consultation without fail.

■ Standard Products

W.V. (V)	Cap. (-10 to +30%) (μ F)	Case size		Specification		Terminal Pitch (mm)	Part No.	(:) Mounting Clamp		
		Dia.	Length	Ripple current (120Hz) (+85°C) (A)	D.F. (120Hz) (+20°C)			No	2point clamp	3point clamp
		(mm)	(mm)							
35	56000	51	83	8.7	0.35	22.0	ECEG1VU563L()	N	C	F
	68000	51	103	10.5	0.35	22.0	ECEG1VU683K()	N	C	F
	82000	51	125	12.3	0.35	22.0	ECEG1VU823J()	N	C	F
	100000	51	145	15.0	0.35	22.0	ECEG1VU104H()	N	C	F
	120000	64	103	15.2	0.50	28.6	ECEG1VU124G()	N	C	F
	150000	64	125	16.3	0.50	28.6	ECEG1VU154F()	N	C	F
	180000	64	145	18.1	0.50	28.6	ECEG1VU184E()	N	C	F
	220000	77	125	18.7	0.75	31.8	ECEG1VU224D()	N	C	F
	270000	77	145	22.0	0.75	31.8	ECEG1VU274C()	N	C	F
	330000	90	150	25.0	0.90	31.8	ECEG1VU334A()	N		F
50	15000	36	83	3.8	0.30	13.0	ECEG1HU153P()	N	F	
	18000	36	103	4.5	0.30	13.0	ECEG1HU183N()	N	F	
	22000	36	125	5.5	0.30	13.0	ECEG1HU223M()	N	F	
	33000	51	83	6.7	0.35	22.0	ECEG1HU333L()	N	C	F
	47000	51	103	8.7	0.35	22.0	ECEG1HU473K()	N	C	F
	56000	51	125	10.2	0.35	22.0	ECEG1HU563J()	N	C	F
	68000	51	145	12.2	0.35	22.0	ECEG1HU683H()	N	C	F
	82000	64	103	13.1	0.50	28.6	ECEG1HU823G()	N	C	F
	100000	64	125	16.2	0.50	28.6	ECEG1HU104F()	N	C	F
	120000	64	145	17.7	0.50	28.6	ECEG1HU124E()	N	C	F
	150000	77	125	18.1	0.75	31.8	ECEG1HU154D()	N	C	F
	180000	77	145	21.2	0.75	31.8	ECEG1HU184C()	N	C	F
	220000	90	150	26.2	0.90	31.8	ECEG1HU224A()	N		F
63	10000	36	83	3.7	0.25	13.0	ECEG1JU103P()	N	F	
	15000	36	103	5.0	0.25	13.0	ECEG1JU153N()	N	F	
	18000	36	125	6.0	0.25	13.0	ECEG1JU183M()	N	F	
	27000	51	83	7.6	0.30	22.0	ECEG1JU273L()	N	C	F
	33000	51	103	9.7	0.30	22.0	ECEG1JU333K()	N	C	F
	39000	51	125	10.7	0.30	22.0	ECEG1JU393J()	N	C	F
	47000	51	145	12.5	0.30	22.0	ECEG1JU473H()	N	C	F
	56000	64	103	13.7	0.40	28.6	ECEG1JU563G()	N	C	F
	68000	64	125	16.2	0.40	28.6	ECEG1JU683F()	N	C	F
	82000	64	145	20.0	0.40	28.6	ECEG1JU823E()	N	C	F
	100000	77	125	20.6	0.50	31.8	ECEG1JU104D()	N	C	F
	120000	77	145	23.7	0.50	31.8	ECEG1JU124C()	N	C	F
	180000	90	150	31.2	0.60	31.8	ECEG1JU184A()	N		F
80	8200	36	83	3.5	0.25	13.0	ECEG1KU822P()	N	F	
	10000	36	103	4.3	0.25	13.0	ECEG1KU103N()	N	F	
	12000	36	125	5.0	0.25	13.0	ECEG1KU123M()	N	F	
	18000	51	83	6.2	0.25	22.0	ECEG1KU183L()	N	C	F
	22000	51	103	7.5	0.25	22.0	ECEG1KU223K()	N	C	F
	27000	51	125	9.0	0.25	22.0	ECEG1KU273J()	N	C	F

Endurance : 85°C 2000h

Design, Specifications are subject to change without notice. Ask factory for technical specifications before purchase and/or use. Whenever a doubt about safety arises from this product, please inform us immediately for technical consultation without fail.

■ Standard Products

W.V. (V)	Cap. (10 to +30%) (μ F)	Case size		Specification		Terminal Pitch (mm)	Part No.	(:) Mounting Clamp		
		Dia. (mm)	Length (mm)	Ripple current (120Hz) (+85°C) (A)	D.F. (120Hz) (+20°C)			No	2point clamp	3point clamp
80	39000	51	145	11.5	0.25	22.0	ECEG1KU393H()	N	C	F
		64	103	11.5	0.30	28.6	ECEG1KU393G()	N	C	F
	47000	64	125	14.3	0.30	28.6	ECEG1KU473F()	N	C	F
	56000	64	145	15.6	0.30	28.6	ECEG1KU563E()	N	C	F
	68000	77	125	16.8	0.40	31.8	ECEG1KU683D()	N	C	F
	100000	77	145	21.2	0.40	31.8	ECEG1KU104C()	N	C	F
	120000	90	150	26.2	0.50	31.8	ECEG1KU124A()	N		F
100	5600	36	83	2.8	0.20	13.0	ECEG2AU562P()	N	F	
	8200	36	103	3.8	0.20	13.0	ECEG2AU822N()	N	F	
	10000	36	125	4.5	0.20	13.0	ECEG2AU103M()	N	F	
	15000	51	83	5.7	0.20	22.0	ECEG2AU153L()	N	C	F
	18000	51	103	6.7	0.20	22.0	ECEG2AU183K()	N	C	F
	22000	51	125	8.2	0.20	22.0	ECEG2AU223J()	N	C	F
	27000	51	145	9.7	0.20	22.0	ECEG2AU273H()	N	C	F
	33000	64	103	10.5	0.25	28.6	ECEG2AU333G()	N	C	F
	39000	64	125	12.5	0.25	28.6	ECEG2AU393F()	N	C	F
	47000	64	145	14.3	0.25	28.6	ECEG2AU473E()	N	C	F
	56000	77	125	15.6	0.35	31.8	ECEG2AU563D()	N	C	F
	68000	77	145	18.1	0.35	31.8	ECEG2AU683C()	N	C	F
100000	90	150	23.7	0.45	31.8	ECEG2AU104A()	N		F	
160	2200	36	83	2.31	0.15	13.0	ECEG2CU222P()	N	F	
	2700	36	103	2.75	0.15	13.0	ECEG2CU272N()	N	F	
	3300	36	125	3.38	0.15	13.0	ECEG2CU332M()	N	F	
	3900	51	83	3.75	0.15	22.0	ECEG2CU392L()	N	C	F
	5600	51	103	5.00	0.15	22.0	ECEG2CU562K()	N	C	F
	6800	51	125	5.75	0.15	22.0	ECEG2CU682J()	N	C	F
	8200	51	145	6.75	0.15	22.0	ECEG2CU822H()	N	C	F
		64	103	6.75	0.15	28.6	ECEG2CU822G()	N	C	F
	10000	64	125	8.13	0.15	28.6	ECEG2CU103F()	N	C	F
	12000	64	145	9.50	0.15	28.6	ECEG2CU123E()	N	C	F
	15000	77	125	11.2	0.15	31.8	ECEG2CU153D()	N	C	F
	18000	77	145	12.5	0.15	31.8	ECEG2CU183C()	N	C	F
27000	90	150	17.5	0.15	31.8	ECEG2CU273A()	N		F	
200	1800	36	83	2.13	0.15	13.0	ECEG2DU182P()	N	F	
	2200	36	103	2.50	0.15	13.0	ECEG2DU222N()	N	F	
	2700	36	125	3.00	0.15	13.0	ECEG2DU272M()	N	F	
	3300	51	83	3.50	0.15	22.0	ECEG2DU332L()	N	C	F
	4700	51	103	4.50	0.15	22.0	ECEG2DU472K()	N	C	F
	5600	51	125	5.25	0.15	22.0	ECEG2DU562J()	N	C	F
	6800	51	145	6.25	0.15	22.0	ECEG2DU682H()	N	C	F
		64	103	6.25	0.15	28.6	ECEG2DU682G()	N	C	F
8200	64	125	7.38	0.15	28.6	ECEG2DU822F()	N	C	F	

Endurance : 85°C 2000h

■ Standard Products

W.V. (V)	Cap. (10 to +30%) (μ F)	Case size		Specification		Terminal Pitch (mm)	Part No.	(:) Mounting Clamp		
		Dia. (mm)	Length (mm)	Ripple current (120Hz) (+85°C) (A)	D.F. (120Hz) (+20°C)			No	2point clamp	3point clamp
200	10000	64	145	8.63	0.15	28.6	ECEG2DU103E()	N	C	F
	15000	77	125	11.2	0.15	31.8	ECEG2DU153D()	N	C	F
	18000	77	145	13.1	0.15	31.8	ECEG2DU183C()	N	C	F
	22000	90	150	15.6	0.15	31.8	ECEG2DU223A()	N		F
250	1200	36	83	1.75	0.15	13.0	ECEG2EU122P()	N	F	
	1500	36	103	2.13	0.15	13.0	ECEG2EU152N()	N	F	
	1800	36	125	2.50	0.15	13.0	ECEG2EU182M()	N	F	
	2200	51	83	2.88	0.15	22.0	ECEG2EU222L()	N	C	F
	3300	51	103	3.75	0.15	22.0	ECEG2EU332K()	N	C	F
	3900	51	125	4.38	0.15	22.0	ECEG2EU392J()	N	C	F
	4700	51	145	5.25	0.15	22.0	ECEG2EU472H()	N	C	F
		64	103	5.25	0.15	28.6	ECEG2EU472G()	N	C	F
	5600	64	125	6.00	0.15	28.6	ECEG2EU562F()	N	C	F
	6800	64	145	7.13	0.15	28.6	ECEG2EU682E()	N	C	F
	10000	77	125	9.13	0.15	31.8	ECEG2EU103D()	N	C	F
	12000	77	145	10.6	0.15	31.8	ECEG2EU123C()	N	C	F
15000	90	150	13.1	0.15	31.8	ECEG2EU153A()	N		F	

Endurance : 85°C 2000h