

Surface Mount Type

Series: **S** Type : **V**

■ Features Endurance : 85°C 2000 h
5.4 mm (≤ φ6.3) height

■ Specifications

Country of Origin
Japan
Malaysia (φ4,φ5,φ6.3)



| | | | | | | | | | | | | | |
|------------------------------------|--|--------------------------------|-------------|---------------------------------------|----|----|----|----|----|-----|-----------------------------|-----------------------------------|---------------------------|
| Category temp. range | -40 to +85°C | | | | | | | | | | | | |
| Rated W.V. Range | 4 to 100 V .DC | | | | | | | | | | | | |
| Nominal Cap. Range | 0.1 to 1500 μF | | | | | | | | | | | | |
| Capacitance Tolerance | ±20 % (120Hz/+20°C) | | | | | | | | | | | | |
| DC Leakage Current | I ≤ 0.01 CV or 3(μA) after 2 minutes (Bi-Polar I ≤ 0.02 CV or 6 (μA)) (Whichever, greater) | | | | | | | | | | | | |
| tan δ | Please see the attached standard products list | | | | | | | | | | | | |
| Characteristics at Low Temperature | W.V. (V) | 4 | 6.3 | 10 | 16 | 25 | 35 | 50 | 63 | 100 | (Impedance ratio at 120 Hz) | | |
| | -25 / +20 °C | 7 | 4 | 3 | 2 | 2 | 2 | 2 | 3 | 3 | | | |
| | -40 / +20 °C | 15 | 8 | 6 | 4 | 4 | 3 | 3 | 4 | 4 | | | |
| Endurance | After applying rated working voltage for 2000 hours at +85±2°C and then being stabilized at +20°C, capacitors shall meet the following limits. | | | | | | | | | | | | |
| | Capacitance change : ±20% of initial measured value | | | | | | | | | | tan δ | ≤ 200% of initial specified value | |
| | Size code | Rated W.V. | Cap. change | | | | | | | | | DC leakage current | ≤ initial specified value |
| | A(φ3) | 4 to 50W.V. | ±30% | initial measured value for 1000 hours | | | | | | | | | |
| A(φ3) to D8(φ6.3) | 4 W.V. | | | | | | | | | | | | |
| ≤ D(φ6.3)Minature | 6.3 W.V. | ±20% | | | | | | | | | | | |
| | ≥ 10 W.V. | | | | | | | | | | | | |
| Shelf Life | After storage for 1000 hours at +85±2°C with no voltage applied and then being stabilized at +20°C, capacitors shall meet the limits specified in Endurance.(With voltage treatment) | | | | | | | | | | | | |
| Resistance to Soldering Heat | After reflow soldering (Refer to page 184 for recommendable temperature profile.) and then being stabilized at +20°C, capacitor shall meet the following limits. | | | | | | | | | | | | |
| | Capacitance change | ±10% of initial measured value | | | | | | | | | | | |
| | tan δ | ≤ initial specified value | | | | | | | | | | | |
| | DC leakage current | ≤ initial specified value | | | | | | | | | | | |

■ Marking

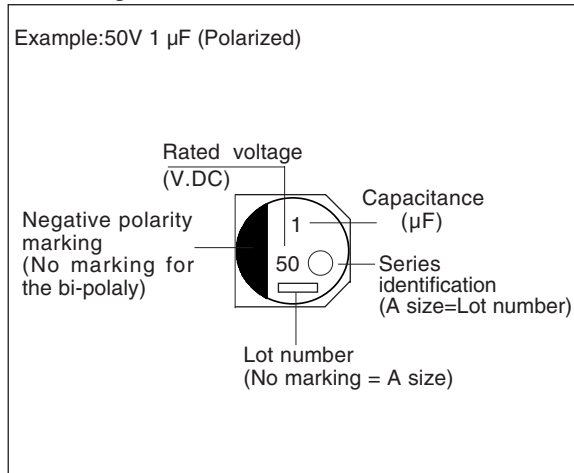

■ Dimensions in mm (not to scale)

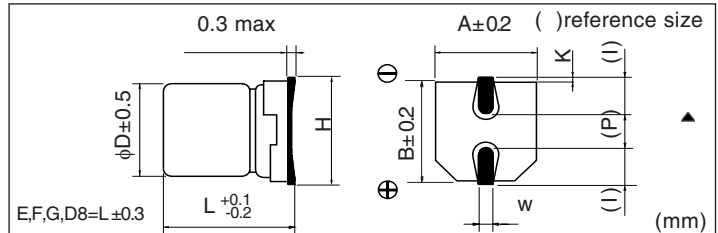

| Size code | D | L | A,B | H | I | W | P | K |
|-----------|------|------|------|---------|-----|----------|-----|---------------------|
| A | 3.0 | 5.4 | 3.3 | 4.5MAX | 1.5 | 0.55±0.1 | 0.6 | 0.35 -0.20 to +0.15 |
| B | 4.0 | 5.4 | 4.3 | 5.5MAX | 1.8 | 0.65±0.1 | 1.0 | 0.35 -0.20 to +0.15 |
| C | 5.0 | 5.4 | 5.3 | 6.5MAX | 2.2 | 0.65±0.1 | 1.5 | 0.35 -0.20 to +0.15 |
| D | 6.3 | 5.4 | 6.6 | 7.8MAX | 2.6 | 0.65±0.1 | 1.8 | 0.35 -0.20 to +0.15 |
| D8 | 6.3 | 7.7 | 6.6 | 7.8MAX | 2.6 | 0.65±0.1 | 1.8 | 0.35 -0.20 to +0.15 |
| E | 8.0 | 6.2 | 8.3 | 9.5MAX | 3.4 | 0.65±0.1 | 2.2 | 0.35 -0.20 to +0.15 |
| F | 8.0 | 10.2 | 8.3 | 10.0MAX | 3.4 | 0.90±0.2 | 3.1 | 0.70±0.2 |
| G | 10.0 | 10.2 | 10.3 | 12.0MAX | 3.5 | 0.90±0.2 | 4.6 | 0.70±0.2 |

■ Case size

| W.V.(V) | 4 (0G) | | 6.3 (0J) | | 10 (1A) | | 16 (1C) | | 25 (1E) | | 35 (1V) | | 50 (1H) | | 63 (1J) | | 100 (2A) | |
|-----------|------------|------------|----------|------------|----------|------------|----------|------------|----------|------------|----------|------------|----------|------------|----------|------------|----------|------|
| Cap. (μF) | Polar-ized | Polar-ized | Bi-polar | Polar-ized | Bi-polar | Polar-ized | Bi-polar | Polar-ized | Bi-polar | Polar-ized | Bi-polar | Polar-ized | Bi-polar | Polar-ized | Bi-polar | Polar-ized | Bi-polar | |
| 0.1 | | | | | | | | | | | | | | A,B | | | | |
| 0.22 | | | | | | | | | | | | | | A,B | B | | | |
| 0.33 | | | | | | | | | | | | | | A,B | B | | | |
| 0.47 | | | | | | | | | | | | | | A,B | B | | | |
| 1.0 | | | | | | | | | | | | | | A,B | B | | | |
| 2.2 | | | | | | | | | | | | | | A,B | C | | | |
| 3.3 | | | | | | | | | | | | | | B | C | | | E |
| 4.7 | | | | | | | | | | | | | | A | C | | | F(E) |
| 10 | | | | | | | | | | | | | | A | C | | | F(E) |
| 22 | A | B(A) | C | (B) | B | A,B | C | C(B) | D | C(B) | D | C(B) | D | D(C) | | D | | G(F) |
| 33 | B | (B) | | C(B) | D | (C) | D | D(C) | | E(D) | | F(E),D8 | | E(D) | | F(E) | | G(F) |
| 47 | B | C(B) | D | (C) | | D(C) | | (D) | | E(D) | | G(F),D8 | | G(F),D8 | | G(F) | | |
| 100 | C | D(C) | | D(C) | | E(D) | | F(E),D8 | | G(F),D8 | | G | | G | | G | | |
| 220 | D | (D) | | E,D8 | | F,D8 | | G(F) | | G(F) | | | | G | | | | |
| 330 | (D) | E,D8 | | F | | G(F) | | G(F) | | G | | | | | | | | |
| 470 | D8 | F | | G(F) | | G(F) | | G | | | | | | | | | | |
| 1000 | | G(F) | | G | | | | | | | | | | | | | | |
| 1500 | | G | | | | | | | | | | | | | | | | |

Design, and specifications are each subject to change without notice. Ask factory for the current technical specifications before purchase and / or use. Should a safety concern arise regarding this product, please be sure to contact us immediately.

■ Standard Products

| W.V. (V) | Cap. (±20%) (μF) | Case size | | | Specification | | | Part No. | Min.Packaging Qty |
|-------------|------------------------|--------------|----------------|--------------|---|-----------------------------|----------------------|--------------|----------------------|
| | | Dia. (mm) | Length (mm) | Size Code | Ripple Current (120Hz) (+85°C) (mA) | tan δ (120Hz) (+20°C) | Endurance (hours) | | Taping (pcs) |
| 4 | 22 | 3 | 5.4 | A | 19 | 0.37 | 1000 | ECEV0GS220SR | 2000 |
| | 33 | 4 | 5.4 | B | 26 | 0.35 | 1000 | ECEV0GA330SR | 2000 |
| | 47 | 4 | 5.4 | B | 34 | 0.35 | 1000 | ECEV0GA470SR | 2000 |
| | 100 | 5 | 5.4 | C | 61 | 0.35 | 1000 | ECEV0GA101SR | 1000 |
| | 220 | 6.3 | 5.4 | D | 82 | 0.35 | 1000 | ECEV0GA221SP | 1000 |
| | 330 | 6.3 | 5.4 | D | 80 | 0.50 | 1000 | ECEV0GA331WP | 1000 |
| | 470 | 6.3 | 7.7 | D8 | 200 | 0.35 | 2000 | ECEV0GA471XP | 900 |
| 6.3 | 22 | 3 | 5.4 | A | 20 | 0.35 | 1000 | ECEV0JS220WR | 2000 |
| | | 4 | 5.4 | B | 29 | 0.26 | 2000 | ECEV0JA220SR | 2000 |
| | 33 | 4 | 5.4 | B | 22 | 0.35 | 1000 | ECEV0JA330WR | 2000 |
| | | 47 | 4 | 5.4 | B | 36 | 0.35 | 1000 | ECEV0JA470WR |
| | 100 | 5 | 5.4 | C | 46 | 0.26 | 2000 | ECEV0JA470SR | 1000 |
| | | 6.3 | 5.4 | C | 47 | 0.35 | 1000 | ECEV0JA101WR | 1000 |
| | 220 | 6.3 | 5.4 | D | 71 | 0.26 | 2000 | ECEV0JA101SP | 1000 |
| | | 74 | 0.35 | 1000 | ECEV0JA221WP | 1000 | | | |
| | 330 | 6.3 | 7.7 | D8 | 188 | 0.26 | 2000 | ECEV0JA331XP | 900 |
| | | 8 | 6.2 | E | 300 | 0.35 | 2000 | ECEV0JA331P | 1000 |
| | 470 | 8 | 10.2 | F | 380 | 0.35 | 2000 | ECEV0JA471P | 500 |
| 1000 | 8 | 10.2 | F | 500 | 0.35 | 2000 | ECEV0JA102UP | 500 | |
| | 10 | 10.2 | G | 700 | 0.35 | 2000 | ECEV0JA102P | 500 | |
| 1500 | 10 | 10.2 | G | 750 | 0.35 | 2000 | ECEV0JA152P | 500 | |
| 10 | 22 | 4 | 5.4 | B | 28 | 0.30 | 1000 | ECEV1AA220WR | 2000 |
| | | 4 | 5.4 | B | 29 | 0.30 | 1000 | ECEV1AA330WR | 2000 |
| | 33 | 5 | 5.4 | C | 43 | 0.20 | 2000 | ECEV1AA330SR | 1000 |
| | | 47 | 5 | 5.4 | C | 47 | 0.30 | 1000 | ECEV1AA470WR |
| | 100 | 5 | 5.4 | C | 50 | 0.30 | 1000 | ECEV1AA101WR | 1000 |
| | | 6.3 | 5.4 | D | 70 | 0.26 | 2000 | ECEV1AA101SP | 1000 |
| | 220 | 6.3 | 7.7 | D8 | 173 | 0.20 | 2000 | ECEV1AA221XP | 900 |
| | | 8 | 6.2 | E | 250 | 0.26 | 2000 | ECEV1AA221P | 1000 |
| | 330 | 8 | 10.2 | F | 390 | 0.26 | 2000 | ECEV1AA331P | 500 |
| | | 470 | 8 | 10.2 | F | 390 | 0.26 | 2000 | ECEV1AA471UP |
| 1000 | 10 | 10.2 | G | 400 | 0.26 | 2000 | ECEV1AA471P | 500 | |
| | 580 | 0.26 | 2000 | ECEV1AA102P | 500 | | | | |
| 16 | 10 | 3 | 5.4 | A | 20 | 0.18 | 1000 | ECEV1CS100SR | 2000 |
| | | 4 | 5.4 | B | 28 | 0.16 | 2000 | ECEV1CA100SR | 2000 |
| | 22 | 4 | 5.4 | B | 28 | 0.26 | 1000 | ECEV1CA220WR | 2000 |
| | | 5 | 5.4 | C | 39 | 0.16 | 2000 | ECEV1CA220SR | 1000 |
| | 33 | 5 | 5.4 | C | 35 | 0.26 | 1000 | ECEV1CA330WR | 1000 |
| | | 47 | 5 | 5.4 | C | 39 | 0.26 | 1000 | ECEV1CA470WR |
| | 100 | 6.3 | 5.4 | D | 70 | 0.16 | 2000 | ECEV1CA470SP | 1000 |
| | | 70 | 0.26 | 1000 | ECEV1CA101WP | 1000 | | | |
| | 220 | 8 | 6.2 | E | 200 | 0.20 | 2000 | ECEV1CA101P | 1000 |
| | | 6.3 | 7.7 | D8 | 162 | 0.16 | 2000 | ECEV1CA221XP | 900 |
| | 8 | 10.2 | F | 280 | 0.20 | 2000 | ECEV1CA221P | 500 | |

The taping dimension are explained on p.187 of our Catalog.

Please use it as a reference guide.

Design, and specifications are each subject to change without notice. Ask factory for the current technical specifications before purchase and / or use. Should a safety concern arise regarding this product, please be sure to contact us immediately.

■ Standard Products

| W.V. (V) | Cap. (±20%) (μF) | Case size | | | Specification | | | Part No. | Min.Packaging Q'ty |
|-------------|------------------------|--------------|----------------|--------------|---|-----------------------------|----------------------|--------------|-----------------------|
| | | Dia. (mm) | Length (mm) | Size Code | Ripple Current (120Hz) (+85°C) (mA) | tan δ (120Hz) (+20°C) | Endurance (hours) | | Taping (pcs) |
| 16 | 330 | 8 | 10.2 | F | 320 | 0.20 | 2000 | ECEV1CA331UP | 500 |
| | | 10 | 10.2 | G | 380 | 0.20 | 2000 | ECEV1CA331P | 500 |
| | 470 | 8 | 10.2 | F | 350 | 0.20 | 2000 | ECEV1CA471UP | 500 |
| | | 10 | 10.2 | G | 420 | 0.20 | 2000 | ECEV1CA471P | 500 |
| 25 | 4.7 | 3 | 5.4 | A | 12 | 0.16 | 1000 | ECEV1ES4R7SR | 2000 |
| | | 4 | 5.4 | B | 22 | 0.14 | 2000 | ECEV1EA4R7SR | 2000 |
| | 10 | 4 | 5.4 | B | 22 | 0.20 | 1000 | ECEV1EA100WR | 2000 |
| | | 5 | 5.4 | C | 28 | 0.14 | 2000 | ECEV1EA100SR | 1000 |
| | 22 | 5 | 5.4 | C | 35 | 0.20 | 1000 | ECEV1EA220WR | 1000 |
| | | 6.3 | 5.4 | D | 55 | 0.14 | 2000 | ECEV1EA220SP | 1000 |
| | 33 | 5 | 5.4 | C | 42 | 0.20 | 1000 | ECEV1EA330WR | 1000 |
| | | 6.3 | 5.4 | D | 65 | 0.14 | 2000 | ECEV1EA330SP | 1000 |
| | 47 | 6.3 | 5.4 | D | 70 | 0.20 | 1000 | ECEV1EA470WP | 1000 |
| | | 6.3 | 7.7 | D8 | 143 | 0.14 | 2000 | ECEV1EA101XP | 900 |
| | 100 | 8 | 6.2 | E | 91 | 0.16 | 2000 | ECEV1EA101UP | 1000 |
| | | 8 | 10.2 | F | 180 | 0.16 | 2000 | ECEV1EA101P | 500 |
| | 220 | 8 | 10.2 | F | 230 | 0.16 | 2000 | ECEV1EA221UP | 500 |
| | | 10 | 10.2 | G | 310 | 0.16 | 2000 | ECEV1EA221P | 500 |
| | 330 | 8 | 10.2 | F | 270 | 0.16 | 2000 | ECEV1EA331UP | 500 |
| | | 10 | 10.2 | G | 340 | 0.16 | 2000 | ECEV1EA331P | 500 |
| 470 | 10 | 10.2 | G | 380 | 0.16 | 2000 | ECEV1EA471P | 500 | |
| 35 | 2.2 | 3 | 5.4 | A | 8 | 0.14 | 1000 | ECEV1VS2R2SR | 2000 |
| | | 3 | 5.4 | A | 10 | 0.14 | 1000 | ECEV1VS3R3SR | 2000 |
| | 4.7 | 4 | 5.4 | B | 22 | 0.12 | 2000 | ECEV1VA4R7SR | 2000 |
| | | 4 | 5.4 | B | 22 | 0.16 | 1000 | ECEV1VA100WR | 2000 |
| | 10 | 5 | 5.4 | C | 30 | 0.12 | 2000 | ECEV1VA100SR | 1000 |
| | | 5 | 5.4 | C | 36 | 0.16 | 1000 | ECEV1VA220WR | 1000 |
| | 22 | 6.3 | 5.4 | D | 60 | 0.12 | 2000 | ECEV1VA220SP | 1000 |
| | | 6.3 | 5.4 | D | 60 | 0.16 | 1000 | ECEV1VA330WP | 1000 |
| | 33 | 8 | 6.2 | E | 130 | 0.14 | 2000 | ECEV1VA330P | 1000 |
| | | 6.3 | 5.4 | D | 70 | 0.16 | 1000 | ECEV1VA470WP | 1000 |
| | 47 | 8 | 6.2 | E | 165 | 0.14 | 2000 | ECEV1VA470P | 1000 |
| | | 6.3 | 7.7 | D8 | 132 | 0.12 | 2000 | ECEV1VA101XP | 900 |
| | 100 | 8 | 10.2 | F | 140 | 0.14 | 2000 | ECEV1VA101UP | 500 |
| | | 10 | 10.2 | G | 210 | 0.14 | 2000 | ECEV1VA101P | 500 |
| | 220 | 8 | 10.2 | F | 200 | 0.14 | 2000 | ECEV1VA221UP | 500 |
| | | 10 | 10.2 | G | 310 | 0.14 | 2000 | ECEV1VA221P | 500 |
| 330 | 10 | 10.2 | G | 350 | 0.14 | 2000 | ECEV1VA331P | 500 | |
| | 0.1 | 3 | 5.4 | A | 1 | 0.14 | 1000 | ECEV1HS0R1SR | 2000 |
| 50 | 0.1 | 4 | 5.4 | B | 1 | 0.12 | 2000 | ECEV1HA0R1SR | 2000 |
| | | 0.22 | 3 | 5.4 | A | 2 | 0.14 | 1000 | ECEV1HSR22SR |
| | 0.22 | 4 | 5.4 | B | 2 | 0.12 | 2000 | ECEV1HAR22SR | 2000 |
| | | 0.33 | 3 | 5.4 | A | 3 | 0.14 | 1000 | ECEV1HSR33SR |
| | 0.33 | 4 | 5.4 | B | 3 | 0.12 | 2000 | ECEV1HAR33SR | 2000 |

The taping dimension are explained on p.187of our Catalog.
Please use it as a reference guide.

Design, and specifications are each subject to change without notice. Ask factory for the current technical specifications before purchase and / or use. Should a safety concern arise regarding this product, please be sure to contact us immediately.

■ Standard Products

| W.V. (V) | Cap. (±20%) (μF) | Case size | | | Specification | | | Part No. | Min.Packaging Qty |
|-------------|------------------------|--------------|----------------|--------------|---|-----------------------------|----------------------|--------------|----------------------|
| | | Dia. (mm) | Length (mm) | Size Code | Ripple Current (120Hz) (+85°C) (mA) | tan δ (120Hz) (+20°C) | Endurance (hours) | | Taping (pcs) |
| 50 | 0.47 | 3 | 5.4 | A | 5 | 0.14 | 1000 | ECEV1HSR47SR | 2000 |
| | | 4 | 5.4 | B | 5 | 0.12 | 2000 | ECEV1HAR47SR | 2000 |
| | 1 | 3 | 5.4 | A | 8 | 0.14 | 1000 | ECEV1HS010SR | 2000 |
| | | 4 | 5.4 | B | 10 | 0.12 | 2000 | ECEV1HA010SR | 2000 |
| | 2.2 | 3 | 5.4 | A | 10 | 0.14 | 1000 | ECEV1HS2R2SR | 2000 |
| | | 4 | 5.4 | B | 16 | 0.12 | 2000 | ECEV1HA2R2SR | 2000 |
| | 3.3 | 4 | 5.4 | B | 16 | 0.12 | 2000 | ECEV1HA3R3SR | 2000 |
| | 4.7 | 4 | 5.4 | B | 18 | 0.14 | 1000 | ECEV1HA4R7WR | 2000 |
| | | 5 | 5.4 | C | 23 | 0.12 | 2000 | ECEV1HA4R7SR | 1000 |
| | 10 | 5 | 5.4 | C | 27 | 0.14 | 1000 | ECEV1HA100WR | 1000 |
| | | 6.3 | 5.4 | D | 35 | 0.12 | 2000 | ECEV1HA100SP | 1000 |
| | 22 | 6.3 | 5.4 | D | 40 | 0.14 | 1000 | ECEV1HA220WP | 1000 |
| | | 8 | 6.2 | E | 120 | 0.12 | 2000 | ECEV1HA220P | 1000 |
| | 33 | 6.3 | 7.7 | D8 | 65 | 0.12 | 2000 | ECEV1HA330XP | 900 |
| | | 8 | 6.2 | E | 65 | 0.12 | 2000 | ECEV1HA330UP | 1000 |
| | | 8 | 10.2 | F | 110 | 0.12 | 2000 | ECEV1HA330P | 500 |
| | 47 | 6.3 | 7.7 | D8 | 105 | 0.12 | 2000 | ECEV1HA470XP | 900 |
| | | 8 | 10.2 | F | 110 | 0.12 | 2000 | ECEV1HA470UP | 500 |
| | | 10 | 10.2 | G | 130 | 0.12 | 2000 | ECEV1HA470P | 500 |
| | 100 | 8 | 10.2 | F | 200 | 0.12 | 2000 | ECEV1HA101UP | 500 |
| 10 | | 10.2 | G | 250 | 0.12 | 2000 | ECEV1HA101P | 500 | |
| 220 | 10 | 10.2 | G | 300 | 0.12 | 2000 | ECEV1HA221P | 500 | |
| 63 | 10 | 6.3 | 5.4 | D | 35 | 0.18 | 2000 | ECEV1JA100SP | 1000 |
| | 22 | 8 | 6.2 | E | 35 | 0.18 | 2000 | ECEV1JA220UP | 1000 |
| | | 8 | 10.2 | F | 40 | 0.18 | 2000 | ECEV1JA220P | 500 |
| | 33 | 8 | 10.2 | F | 45 | 0.18 | 2000 | ECEV1JA330P | 500 |
| | 47 | 8 | 10.2 | F | 45 | 0.18 | 2000 | ECEV1JA470UP | 500 |
| | | 10 | 10.2 | G | 50 | 0.18 | 2000 | ECEV1JA470P | 500 |
| 100 | 10 | 10.2 | G | 60 | 0.18 | 2000 | ECEV1JA101P | 500 | |
| 100 | 3.3 | 8 | 6.2 | E | 50 | 0.18 | 2000 | ECEV2AA3R3P | 1000 |
| | 4.7 | 8 | 6.2 | E | 50 | 0.18 | 2000 | ECEV2AA4R7UP | 1000 |
| | | 8 | 10.2 | F | 80 | 0.18 | 2000 | ECEV2AA4R7P | 500 |
| | 10 | 8 | 6.2 | E | 50 | 0.18 | 2000 | ECEV2AA100UP | 1000 |
| | | 8 | 10.2 | F | 85 | 0.18 | 2000 | ECEV2AA100P | 500 |
| | 22 | 8 | 10.2 | F | 70 | 0.18 | 2000 | ECEV2AA220UP | 500 |
| | | 10 | 10.2 | G | 85 | 0.18 | 2000 | ECEV2AA220P | 500 |
| | 33 | 10 | 10.2 | G | 90 | 0.18 | 2000 | ECEV2AA330P | 500 |

The taping dimension are explained on p.187of our Catalog.

Please use it as a reference guide.

■ Standard Products(Bi-polar)

| W.V. (V) | Cap. (±20%) (μF) | Case size | | | Specification | | | Part No. | Min.Packaging Qty |
|-------------|------------------------|--------------|----------------|-----------|--|-----------------------------|----------------------|--------------|-------------------|
| | | Dia. (mm) | Length (mm) | Size Code | Ripple Current (120Hz) (+85°C) (mA) | tan δ (120Hz) (+20°C) | Endurance (hours) | | Taping (pcs) |
| 6.3 | 22 | 5 | 5.4 | C | 29 | 0.52 | 2000 | ECEV0JA220NR | 1000 |
| | 47 | 6.3 | 5.4 | D | 46 | 0.52 | 2000 | ECEV0JA470NP | 1000 |
| 10 | 10 | 4 | 5.4 | B | 25 | 0.40 | 2000 | ECEV1AA100NR | 2000 |
| | 33 | 6.3 | 5.4 | D | 43 | 0.40 | 2000 | ECEV1AA330NP | 1000 |
| 16 | 4.7 | 4 | 5.4 | B | 20 | 0.32 | 2000 | ECEV1CA4R7NR | 2000 |
| | 10 | 5 | 5.4 | C | 25 | 0.32 | 2000 | ECEV1CA100NR | 1000 |
| | 22 | 6.3 | 5.4 | D | 39 | 0.32 | 2000 | ECEV1CA220NP | 1000 |
| 25 | 3.3 | 4.0 | 5.4 | B | 12 | 0.28 | 2000 | ECEV1EA3R3NR | 2000 |
| | 4.7 | 5 | 5.4 | C | 21 | 0.28 | 2000 | ECEV1EA4R7NR | 1000 |
| | 10 | 6.3 | 5.4 | D | 28 | 0.28 | 2000 | ECEV1EA100NP | 1000 |
| 35 | 2.2 | 4 | 5.4 | B | 12 | 0.24 | 2000 | ECEV1VA2R2NR | 2000 |
| | 4.7 | 5 | 5.4 | C | 22 | 0.24 | 2000 | ECEV1VA4R7NR | 1000 |
| | 10 | 6.3 | 5.4 | D | 30 | 0.24 | 2000 | ECEV1VA100NP | 1000 |
| 50 | 0.22 | 4 | 5.4 | B | 2 | 0.24 | 2000 | ECEV1HAR22NR | 2000 |
| | 0.33 | 4 | 5.4 | B | 3 | 0.24 | 2000 | ECEV1HAR33NR | 2000 |
| | 0.47 | 4 | 5.4 | B | 5 | 0.24 | 2000 | ECEV1HAR47NR | 2000 |
| | 1 | 4 | 5.4 | B | 10 | 0.24 | 2000 | ECEV1HA010NR | 2000 |
| | 2.2 | 5 | 5.4 | C | 16 | 0.24 | 2000 | ECEV1HA2R2NR | 1000 |
| | 3.3 | 5 | 5.4 | C | 21 | 0.24 | 2000 | EEVNZ1H3R3R | 1000 |
| | 4.7 | 6.3 | 5.4 | D | 31 | 0.24 | 2000 | ECEV1HA4R7NP | 1000 |

The taping dimension are explained on p.187of our Catalog.
Please use it as a reference guide.