

SDB Series

SDB 1005 Type

FEATURES

- ⊙ Low profile.
- ⊙ Magnetically shielded and low DC resistance.
- ⊙ Surface for large currents.
- ⊙ Available on tape and reel for auto-insertion.
- ⊙ Ideal for a variety of DC-DC converter inductor applications.

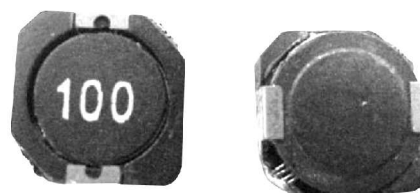

ELECTRICAL CHARACTERISTICS

- ⊙ Tested at 100KHz.
- ⊙ Inductance drop = 30% typ. at rated IDC
- ⊙ Operating temperature range -25°C ~ +85°C

STANDARD ELECTRICAL SPECIFICATION

Part number	Inductance [μ H]	Inductance Tolerance	DC Resistance [Ω] (max.)	I.D.C [A] (max.)
0R8	0.8	± 30%	4.3	7.50
1R5	1.5		7.00	
2R2	2.2		6.30	
3R3	3.3		5.75	
4R7	4.7		4.75	
6R8	6.8		4.10	
8R2	8.2		4.00	
100	10		3.75	
150	15		2.65	
220	22		1.80	
330	33		1.65	
470	47		1.50	
560	56		1.45	
680	68		1.20	
820	82		0.95	
101	100		0.90	
151	150		0.80	
221	220		0.70	
331	330		0.50	

CONSTRUCTION

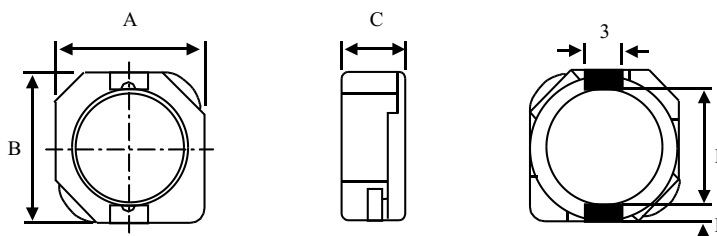

DIMENSIONS : mm

A	B	C	E	F
10.3 max.	10.4 max.	5.0 max.	7.7	1.2