

TERMINATIONS

TYPE N

DC - 18 GHz

2 Watts



MODELS: TNXXXM, TNXXXF, TNXXMC, TNXXFC

SPECIFICATIONS:

Electrical:

Frequency Range	DC - 18 GHz
Standard Freq. Values	6, 12.4 & 18 GHz
VSWR	
DC - 4 GHz	1.10:1 Max.
4 - 8 GHz	1.15:1 Max.
8 - 12.4 GHz	1.20:1 Max.
12.4 - 18 GHz	1.25:1 Max.
Impedance	50 Ohms
Input Power	2 Watts Avg. @ +25°C <small>Derated Linearly to 1 Watt @ +125°C</small>
Peak Power	250 Watts Max. <small>(5uSec Pulse, .05% Duty Cycle)</small>
Operating Temp Range	-65°C to +125°C
Temperature Coefficient	±250 ppm/°C

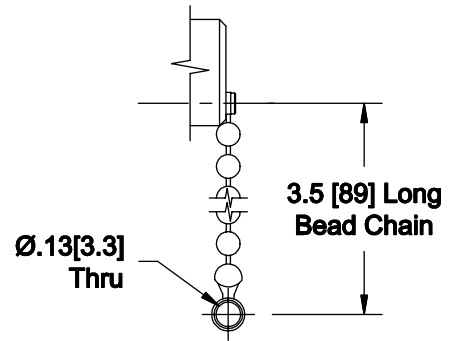

CHAIN DETAIL

Mechanical:

Type N Connectors	Passivated Stainless Steel
<small>Mates with MIL-STD-348</small>	
Conductors	Gold Plated Beryllium Copper
Bead Chain	Passivated Stainless Steel

Model Number: **TNXXXM**
Type N Male Connector

Model Number: **TNXXXF**
Type N Female Connector

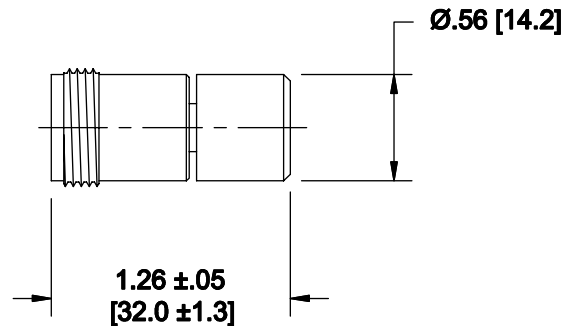
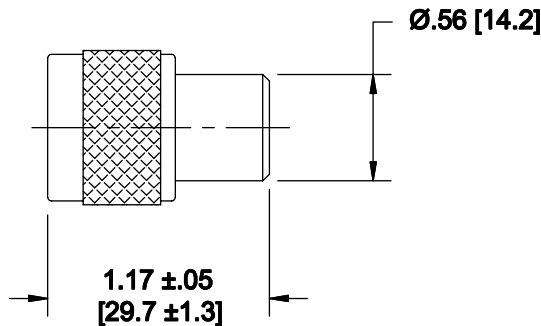

HOW TO ORDER:

Model Number: **TNXXXYZ**

Frequency Range

- 060 = DC - 6 GHz
- 120 = DC - 12.4 GHz
- 180 = DC - 18 GHz

Style

- = No Chain
- C = Chain Included

Connector Configuration

- M = Male
- F = Female

Ordering Examples:

Model Number: **TN180MC**
DC - 18 GHz; Type N Male; Chain Included

Model Number: **TN060F**
DC - 6 GHz; Type N Female; No Chain

Model Number: **TN120M**
DC - 12.4 GHz; Type N Male; No Chain

Note: Dimensions in Brackets are Expressed in Millimeters and are for Reference Only.
Units which operate over a more specific band, or with very low return loss (VSWR), across a specific band or entire frequency range are also available.

TN180; REV G