

Call Toll Free
877.342.3773

PERFORMANCE HIGHLIGHTS

- Stable, Reliable Operation
- Highly Repeatable
- Thermally Stable
- Wavelength Specific

DIMENSIONS: METRIC/ENGLISH



FC (PC)

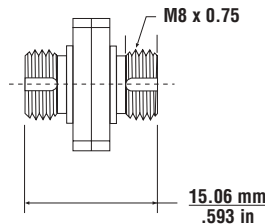
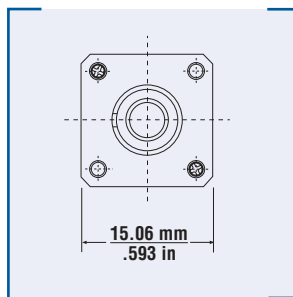

SC (PC)

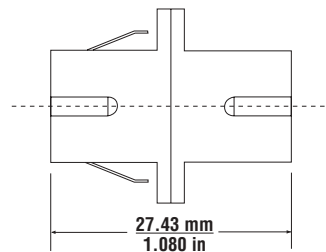
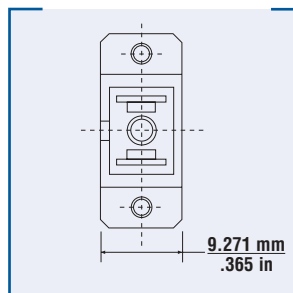

ST (PC)

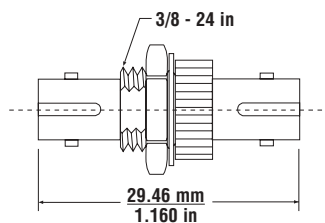
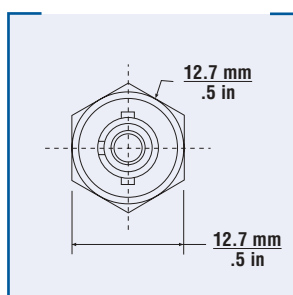

For those applications where return loss is not as critical and price is a consideration, Storm Products—Fiber Optics' bulkhead attenuators fit the requirements.

Available from stock, these fixed optical attenuators (FOAs) are not air-gap. Rather, they use a proven optical filter method of attenuation.

Our bulkhead attenuators are available in both singlemode and multimode filter versions. They are optically tested, chemically resistant to alcohol cleaning, labeled for easy identification and compatible with flat and PC polish.



Call Toll Free
877.342.3773

ATTENUATOR: Fixed-Bulkhead Singlemode and Multimode

SPECIFICATIONS

Operating Window	850, 1310, 1550 nm
Attenuation*†	
* Tested at specified wavelength at room temperature.	5 dB ± 1.5 dB
	10 dB ± 1.5 dB
† Consult factory for other attenuation levels.	15 dB ± 1.5 dB
	20 dB ± 2.0 dB
Operating Temperature	-5 to 50°C
Telcordia GR-63-CORE	
Storage Temperature	-40 to 70°C
Telcordia GR-910-CORE	

CONNECTOR STYLE	BODY MATERIAL	SLEEVE MATERIAL/STYLE	WEIGHT/100 pcs W/DUSTCAPS g (oz)
FC	Nickel Plated	Phosphor	919
	Brass	Bronze	(32)
SC	Molded	Phosphor	372
	Thermoplastic	Bronze	(13)
ST	Nickel Plated	Phosphor	820
	Zinc Alloy	Bronze	(29)

Designed to meet Telcordia requirements.

Meets environmental criteria specified in Telcordia standard GR-910-CORE.

REPEATABILITY (mate / unmate)

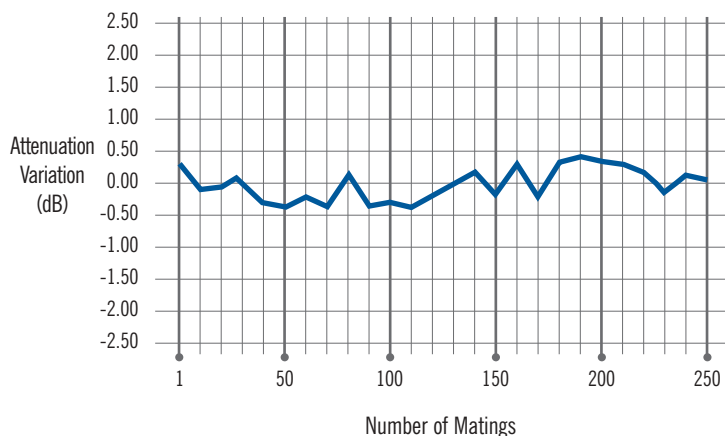

THERMAL STABILITY

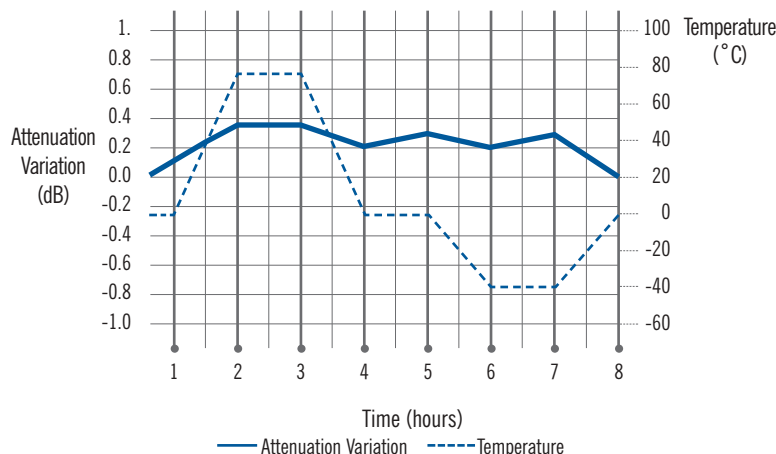

ORDERING INFORMATION

PART NUMBER	DESCRIPTION
68-FF-1- <input type="text" value="05"/> <input type="text" value="85"/>	Attenuator, FC, Bulkhead, Multimode 850 nm
68-FF-1- <input type="text" value="13"/> <input type="text" value="13"/>	Attenuator, FC, Bulkhead, Singlemode and Multimode 1310 nm
68-FF-1- <input type="text" value="15"/> <input type="text" value="15"/>	Attenuator, FC, Bulkhead, Singlemode 1550 nm
68-YY-8- <input type="text" value="05"/> <input type="text" value="85"/>	Attenuator, SC, Bulkhead, Multimode 850 nm
68-YY-8- <input type="text" value="13"/> <input type="text" value="13"/>	Attenuator, SC, Bulkhead, Singlemode and Multimode 1310 nm
68-YY-8- <input type="text" value="15"/> <input type="text" value="15"/>	Attenuator, SC, Bulkhead, Singlemode 1550 nm
68-JJ-7- <input type="text" value="05"/> <input type="text" value="85"/>	Attenuator, ST, Bulkhead, Multimode 850 nm
68-JJ-7- <input type="text" value="13"/> <input type="text" value="13"/>	Attenuator, ST, Bulkhead, Singlemode and Multimode 1310 nm
68-JJ-7- <input type="text" value="15"/> <input type="text" value="15"/>	Attenuator, ST, Bulkhead, Singlemode 1550 nm



Attenuation in dB
available in 05, 10, 15, 20
(consult factory for other attenuation levels)

EXAMPLE: 68-FF-1-0585
FC, Bulkhead Style Attenuator, 5 dB
Multimode, 850 nm